

Explosietekeningen

In het nu volgende deel zijn de explosietekeningen van de machine opgenomen. De tekeningen met hun volledige details kunnen helpen de machine beter te leren kennen.

Onderkastgroep

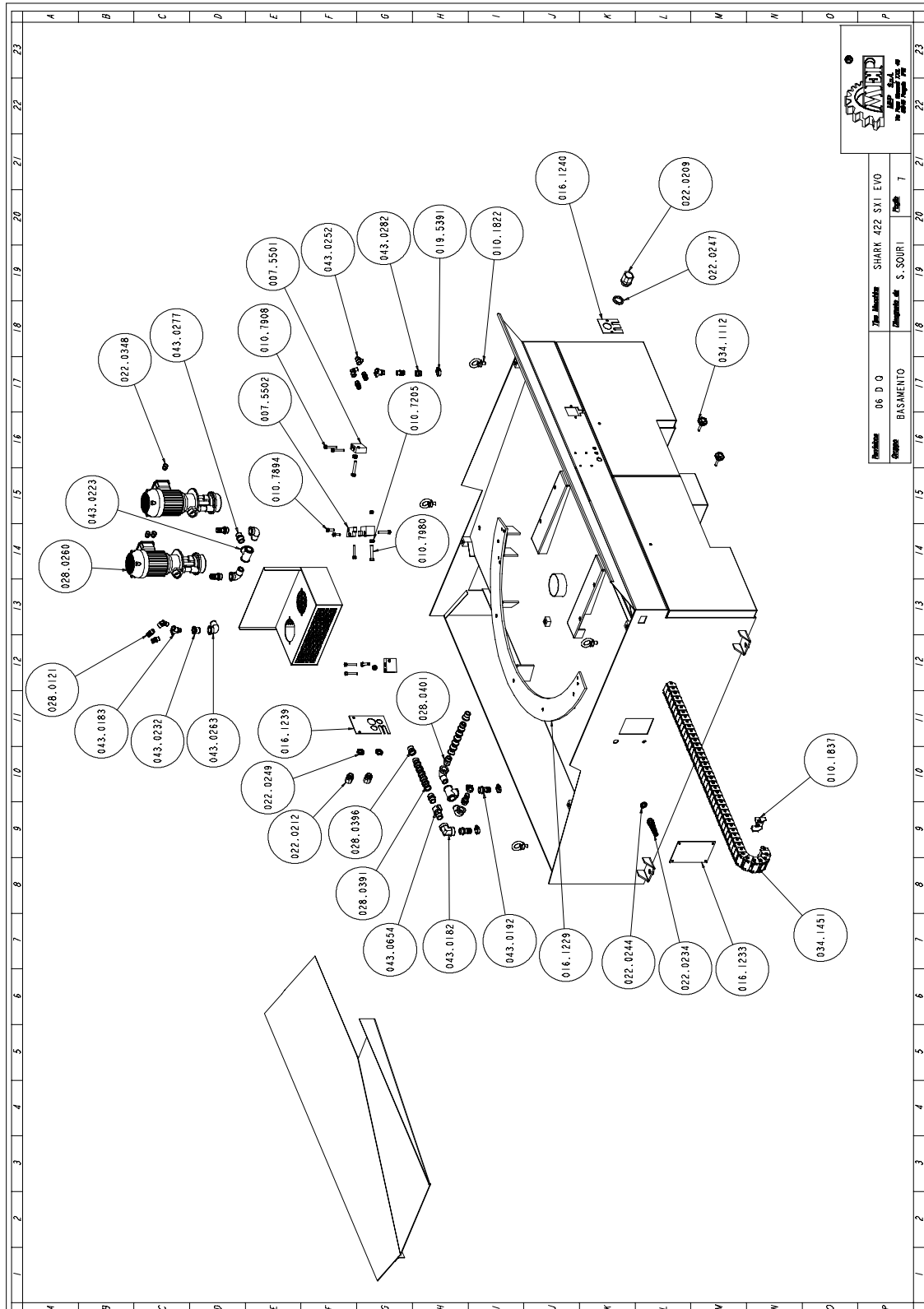

Art. NR.	Benaming	M.	Hoeveelheid
007.5501	TASSELLO-BATT-45SX-60DX-SH420.PRT	NR	2
007.5502	TASSELLO-BATTUTA-45DX-SH420.ASM	NR	1
010.1822	GOLFARE-MASCHIO-M12-ZIN-SH420.PRT	NR	4
010.1837	SET-ATTACCHI-AX-CNC-NT.PRT	NR	1
010.7205	DADO-M10.PRT	NR	3
010.7221	DADO-M16-BASSO.PRT	NR	4
010.7229	DADO-AUTOB-M8.PRT	NR	1
010.7603	ROSETTA-6_4X12_5.PRT	NR	2
010.7868	M6X12-TCEI.PRT	NR	2
010.7894	M8X25-TCEI.PRT	NR	2
010.7908	M8X50-TCEI.PRT	NR	6
010.7980	M10X60-TE.PRT	NR	3
010.7995	M6X16-TSPEI.PRT	NR	5
010.9125	M8X60-VCEI-P.PRT	NR	2
013.0180	PIEDISTALLO-SHARK-420.ASM	NR	1
016.1229	PIASTRA-DI-ROTAZIONE.PRT	NR	1
016.1233	PIASTRA-COP-INTERR-SH331CCS.PRT	NR	1
016.1239	MOSTRINA-POST-SH422-SXI-EVO.PRT	NR	1
016.1240	MOSTRINA-ANTERIORE-BAS-SXI-EVO.PRT	NR	1
019.5391	FASCETTA-MINUS-GT-16X25.PRT	NR	4
022.0209	PG-29-KIEPE.PRT	NR	1
022.0212	PG-16-KIEPE.PRT	NR	2
022.0234	PASSACAVO-PG13_5.PRT	NR	1
022.0244	DADO-PASSACAVO-PG13_5.PRT	NR	1
022.0247	DADO-POLIAM-HUMMEL-262-2900-11.PRT	NR	1
022.0249	DADO-PASSACAVO-PG16.PRT	NR	2
022.0348	ADATTATORE-16-11-M16PG11.PRT	NR	3
028.0121	RACCORDO-3_8-17CL2601.PRT	NR	5
028.0260	ELETTROPOMPA-LPA25_120KW037V230.PRT	NR	2
028.0391	TUBO-LOOC-LINE-SPD-3_4.PRT	NR	2
028.0396	UGELLO-0-20SPD-FP50-11B50.PRT	NR	2
028.0401	RACCORDO-3_4SPD-FP50-11B50.PRT	NR	2
034.0901	TAPPO-LIVELLO-OLIO-1_2-GAS.PRT	NR	1
034.1112	VOLANTINO-DIA_40M8XPIED_SH-CO33.PRT	NR	2
034.1451	CATENA-PORTAC-17-04-63-0-AX-CNC.ASM	NR	1
043.0182	RACCORDO-A-GOMITO-FF-3_4ZINCATO.PRT	NR	1
043.0183	RACCORDO-A-Y-90-3_8.PRT	NR	2
043.0192	RACCORDO-RB-9889-3_4X20.PRT	NR	5
043.0223	RACCORDO-TE-FFF-3_4-ZINCATO.PRT	NR	2
043.0232	RIDUZIONE-ZINCATA-3_4.PRT	NR	1
043.0252	GOMITO-MF3_8CL2020.PRT	NR	3
043.0263	RACCORDO-A-GOMITO-MF-ZINCATO3_4.PRT	NR	5
043.0277	NIPPLO-CONICO-ZINCATO-3_4-IDR.PRT	NR	1
043.0282	MANICOTTO-3_8.PRT	NR	1
043.0654	RUBINETTO-MF-3_4.PRT	NR	1

Vaste-tafel groep

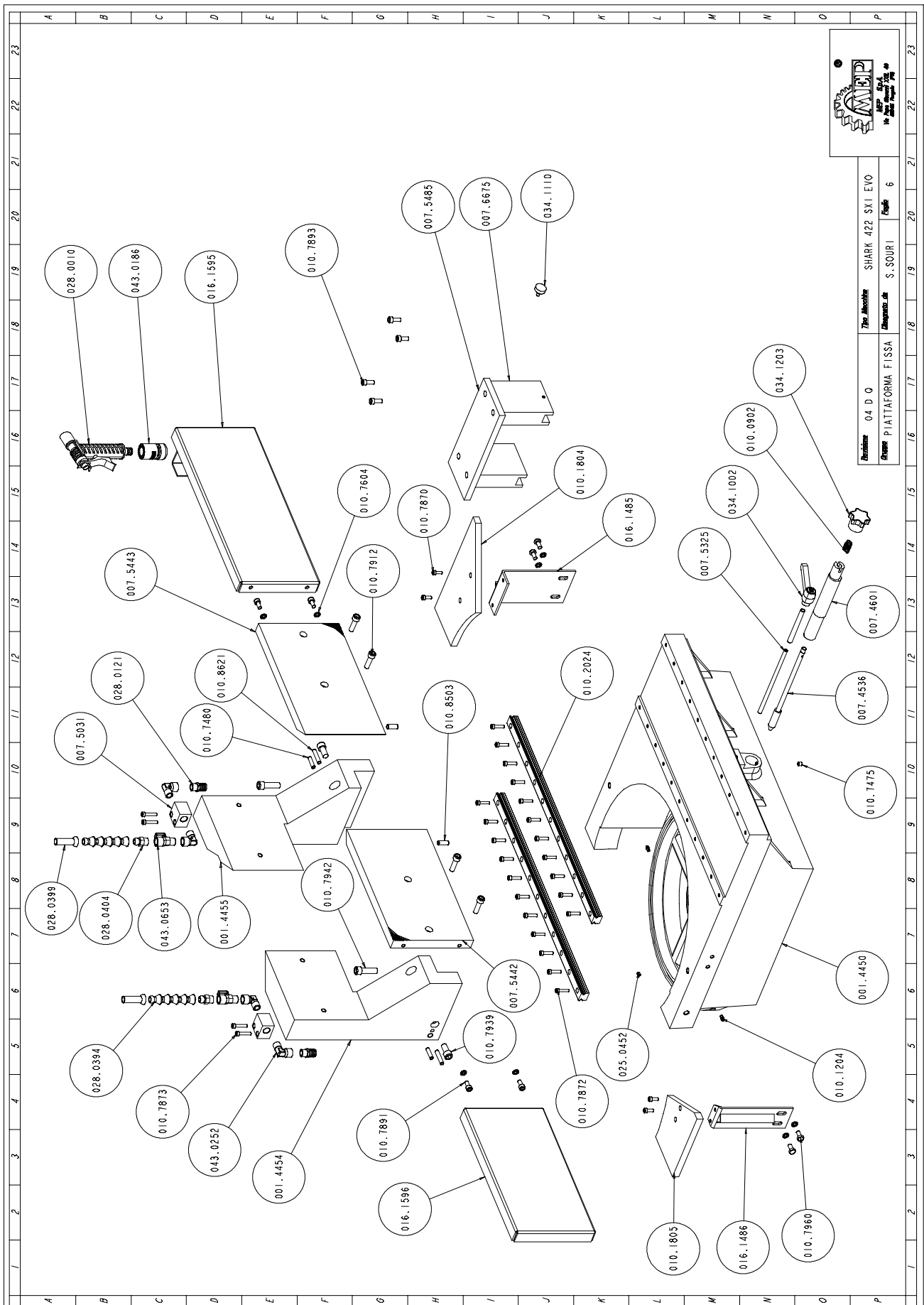

Art. NR.	Benaming	M.	Hoeveelheid	
001.4454	SQUADRO-MORSA-SX-SH420.PRT	NR	1	
001.4455	SQUADRO-MORSA-DX-SH420.PRT	NR	1	
007.4536	PERNO-PFISSO.PRT	NR	1	
007.4601	CLINDRETTO-PFISSO.PRT	NR	1	
007.5031	SQUADRETTO-LIQU-PIANO-GIR-SH400.PRT	NR	2	
007.5325	PERNO-BLOC-PIANO-GIREV-SH420SXI.PRT	NR	1	
007.5442	GANASCIA-FISSA-SINISTRA-SH420.PRT	NR	1	
007.5443	GANASCIA-FISSA-DESTRA-SH420SXI.PRT	NR	1	
007.5485	PIANO-APPOG-BARRA-SUPPLEM-PRT2.PRT	NR	1	
007.6675	PIANO-APPOG-BARRA-SUPPL-1-NT.PRT	NR	2	
010.0902	MOLLA-PFISSO.PRT	NR	1	
010.1204	OLIATORE-A-SFERA-DIA6.PRT	NR	2	
010.1804	CHIUSURA-X-RULLIERA-DX-SH420SXI.PRT	NR	1	
010.1805	CHIUSURA-X-RULLIERA-SX-SH420SXI.PRT	NR	1	
010.2024	GUIDA-HIWIN-LGR-25-640.PRT	NR	2	
010.7475	M8X8-VCEI-P.PRT	NR	1	
010.7480	M8X30-VCEI-P.PRT	NR	2	
010.7604	ROSETTA-8_4X14.PRT	NR	8	
010.7870	M6X16-TCEI.PRT	NR	4	
010.7872	M6X25-TCEI.PRT	2	NR	2
010.7873	M6X30-TCEI.PRT	NR	4	
010.7891	M8X16-TCEI.PRT	NR	4	
010.7893	M8X20-TCEI.PRT	NR	4	
010.7912	M10X35-TCEI.PRT	NR	4	
010.7939	M12X25-TCEI.PRT	NR	2	
010.7942	M12X40-TCEI.PRT	NR	2	
010.7960	M8X16-TE.PRT	NR	4	
010.8503	SPINA-CIL-10X25.PRT	NR	2	
010.8621	SPINA-CIL-8X40.PRT	NR	2	
016.1485	STAFFA-FIX-RULLIERA-DX-SH420.PRT	NR	1	
016.1486	STAFFA-FIX-RULLIERA-SX-SH420.PRT	NR	1	
016.1595	PROLUNGA-GAN-DX-SH420SXI.PRT	NR	1	
016.1596	PROLUNGA-GAN-SX-SH420SXI.PRT	NR	1	
025.0452	RULLINO-6X6AIS1420.PRT	NR	1	
028.0010	PISTOLA.PRT	NR	1	
028.0121	RACCORDO-3_8-17CL2601.PRT	NR	2	
028.0394	TUBO-LOOC-LINE-59861-1_2.PRT	NR	2	
028.0399	UGELLO-12-7-ART59861.PRT	NR	2	
028.0404	RACCORDO3_8-NPT-LOOC-LINE-1_2.PRT	NR	2	
034.1002	LEVA-SCATTÒ-M10.PRT	NR	1	
034.1110	VOLANTINO-DIAM30M6X10.PRT	NR	1	
034.1203	VOL-M10-PFISSO.PRT	NR	1	
043.0186	RACCORDO-FEMMINA1_2AQUASTOP.PRT	NR	1	
043.0252	GOMITO-MF3_8CL2020.PRT	NR	4	
043.0653	RUBINETTO-MF-3_8-CL6310.PRT	NR	2	

Draaiplateaugroep

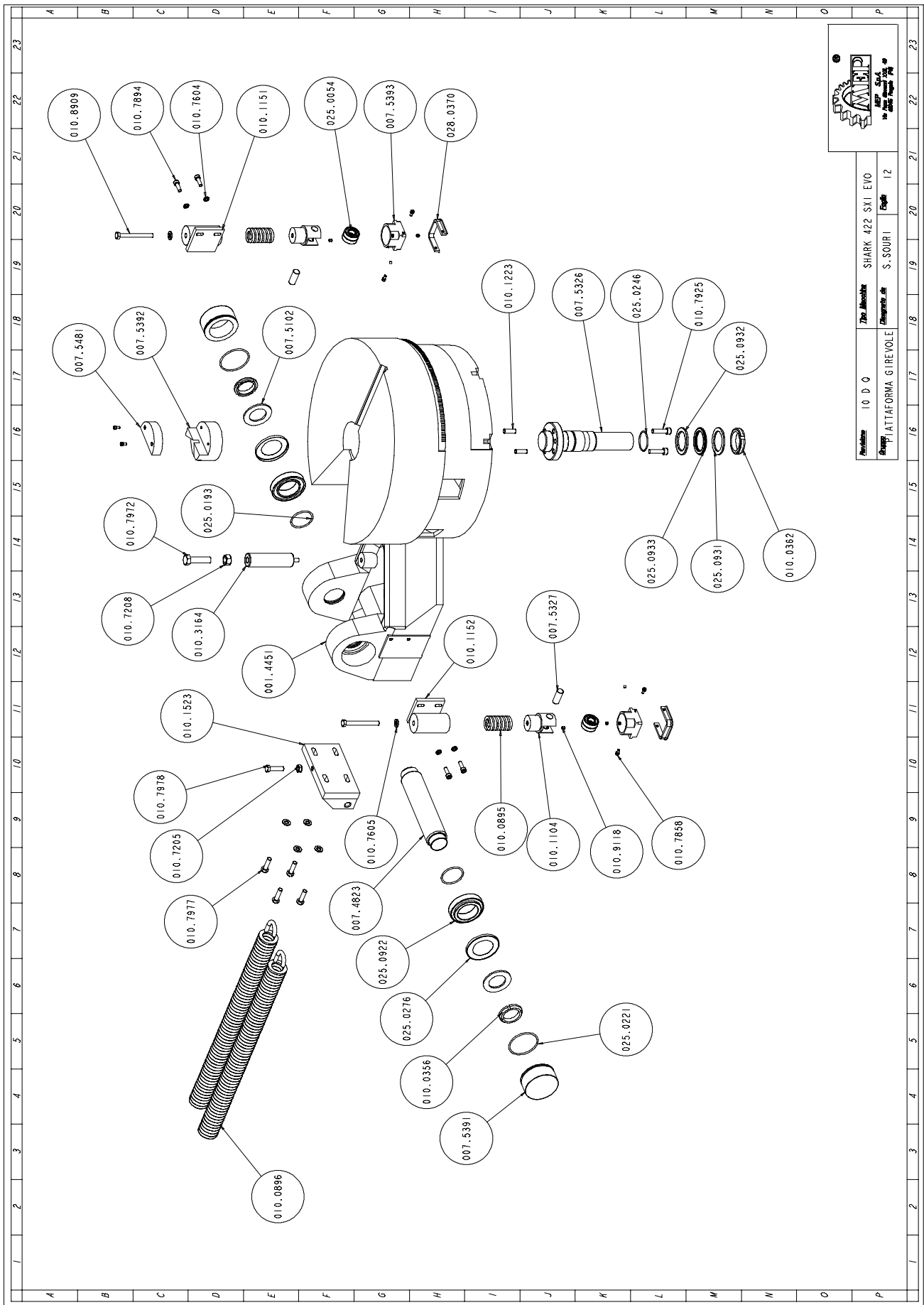

Modello	10 D Q
Descrizione	SHARK 422 SXI EVO
Gruppo	LATTAFORMA GIREVOLE
Disegnato da	S. SQUERI
Esigete	12

Art. NR.	Benaming	M.	Hoeveelheid
001.4451	PIATTAFORMA-ROTANTE-SH420-SE.PRT	NR	1
007.4823	PERNO-SNODO-ARCHETTO-SH400.PRT	NR	1
007.5102	DIST-CUSCINET-SNODO-TESTA-SH400.PRT	NR	2
007.5326	PERNO-DI-CENTRO-SH420SXI.PRT	NR	1
007.5327	PERNO-CUSCIN-AMMORT-SH420SXI.PRT	NR	2
007.5391	BUSS-PERNO-SNODO-TESTA-SH420.PRT	NR	2
007.5392	BUSSOLA-GANASCE-SQUADR-SH420SXI.PRT	NR	1
007.5393	BUSSOLA-RASCHIAPOLVERE-SH420SXI.PRT	NR	2
007.5481	PIASTRA-DI-TAGLIO-SH420SXI.PRT	NR	1
010.0356	GHIERA-45-15.PRT	NR	2
010.0362	GHIERA-50-15.PRT	NR	1
010.0895	MOLLA-AMMORTIZZATORI-SH420SXI.PRT	NR	2
010.0896	MOLLA-STIL-RIC-TESTA-SH400.PRT	NR	2
010.1104	FORCELLA-CUSCINETTI-SH420SXI.PRT	NR	2
010.1151	AMMORTIZZATORE-DX-SH420SXI.PRT	NR	1
010.1152	AMMORTIZZATORE-SX-SH420SXI.PRT	NR	1
010.1223	SPINA-CEMENTATA-10X32-SH420.PRT	NR	2
010.1523	STAF-AGG-DOP-MOL-PIAT-FIX-SH400.PRT	NR	1
010.3164	BATTUTA-FINE-CORSA-TESTA-SH400.PRT	NR	1
010.7205	DADO-M10.PRT	NR	1
010.7208	DADO-M16.PRT	NR	1
010.7604	ROSETTA-8_4X14.PRT	NR	4
010.7605	ROSETTA-10_5X21.PRT	NR	6
010.7858	M5X10-TCEI.PRT	NR	6
010.7894	M8X25-TCEI.PRT	NR	4
010.7925	M10X40-TCEI.PRT	NR	2
010.7972	M16X60-TE.PRT	NR	1
010.7977	M10X35-TE.PRT	NR	4
010.7978	M10X40-TE.PRT	NR	1
010.8909	M10X95-TE.PRT	NR	2
010.9118	M6X6-VCEI-P.PRT	NR	6
025.0054	6203-2Z.PRT	NR	4
025.0193	ANELLO-OR-158.PRT	NR	2
025.0221	ANELLO-OR-176.PRT	NR	2
025.0246	ANELLO-OR-3187.PRT	NR	1
025.0276	NILOS-32011X.PRT	NR	2
025.0922	32011X.PRT	NR	2
025.0931	RALLA-GS81110.PRT	NR	1
025.0932	RALLA-WS81110.PRT	NR	1
025.0933	GABBIA-ASSIALE-K81110.PRT	NR	1
028.0370	BARRETTA-VULCAN-TIPO-VAJ-SH420.PRT	NR	2

Klem groep

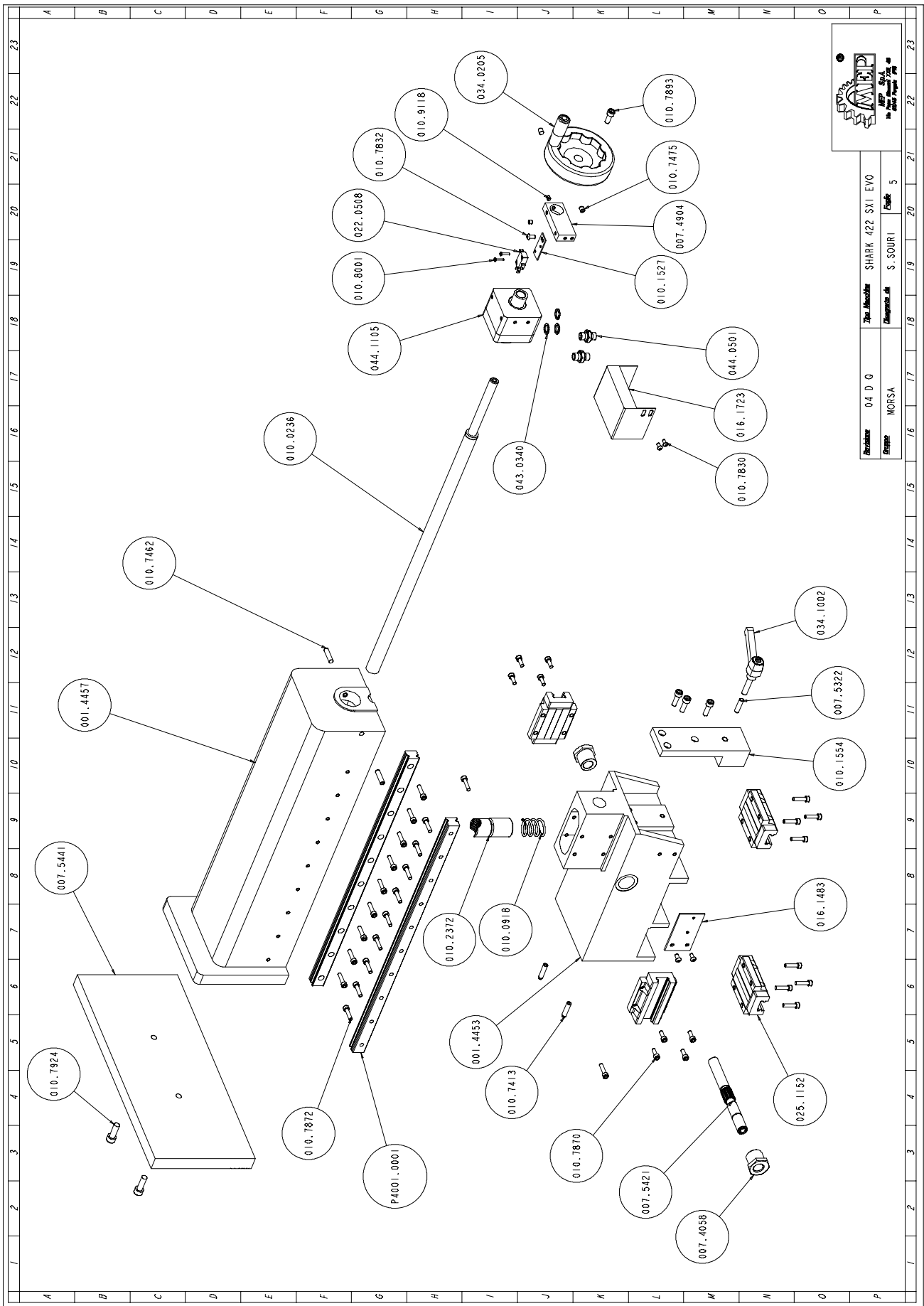

Art. NR.	Benaming	M.	Kvantum	
001.4457	SCORREVOLE-MORSA-SH420.PRT	NR	1	
001.4453	SUPP-SCORREVOLE-MORSA-SH420.PRT	NR	1	
007.4058	007_4058.PRT	NR	2	
007.4904	STAF-SUP-FC-PRES-BARRA-SH400.PRT	NR	1	
007.5322	PERNO-STAF-BLOC-MORSA-SH420SXI.PRT	NR	1	
007.5421	PIGNONE-SBLOC-SCORR-SH420SXI.PRT	NR	1	
007.5441	GANASCIA-MORSA-MOB-SH420SXI.PRT	NR	1	
010.0236	VITE-MORSA-SH420-NEW.PRT	NR	1	
010.0918	010_0918.PRT	NR	1	
010.1527	STAFFA-FIX-FC-PRES-BARRA-SH400.PRT	NR	1	
010.1554	STAFF-BLOC-MORSA-TAGL-SH420SXI.PRT	NR	1	
010.2372	CHIOCCIOLA-MORSA-SH260-280-320.ASM	NR	1	
010.7413	M8X30-VCEI-PR.PRT	NR	2	
010.7454	M8X8-VCEI-PC.PRT	NR	1	
010.7462	M8X30-VCEI-PC.PRT	NR	2	
010.7475	M8X8-VCEI-P.PRT	NR	1	
010.7491	M10X60-VCEI-P.PRT	NR	1	
010.7830	M5X10-BUTTO.PRT	NR	2	
010.7832	M6X12-BUTTO.PRT	NR	3	
010.7859	M5X12-TCEI.PRT	NR	4	
010.7870	M6X16-TCEI.PRT	NR	8	
010.7872	M6X25-TCEI.PRT	2	NR	8
010.7893	M8X20-TCEI.PRT	NR	1	
010.7894	M8X25-TCEI.PRT	NR	7	
010.7924	M10X30-TCEI.PRT	NR	2	
010.8001	VITE-TCIC-M3X16.PRT	NR	2	
010.9118	M6X6-VCEI-P.PRT	NR	2	
016.1483	STAFFA-FIX-CATENA-SH420.PRT	NR	1	
016.1723	PROT-FC-ALIM-PRES-BARRA-SH400.PRT	NR	1	
022.0508	FINE-CORSA-V5B010-CB1.PRT	NR	1	
025.0203	ANELLO-35X25X7.PRT	NR	2	
025.0217	ANELLO-OR-155.PRT	NR	1	
025.0452	RULLINO-6X6AISI420.PRT	NR	1	
025.1152	PATTINO-LGW25HCZ3C.PRT	NR	4	
034.0205	VOLANTINO-MORSA-125.PRT	NR	1	
034.1002	LEVA-SCATTO-M10.PRT	NR	1	
043.0340	RONDELLA-RAME-1_4.PRT	NR	3	
044.0501	NIPPLO-NP-1_4-IDRAULICO.PRT	NR	2	
044.1105	CILINDRO-VOLAMPRESS-D-E-SH400.ASM	NR	1	

Doorsnede-aandrijf wiel groep

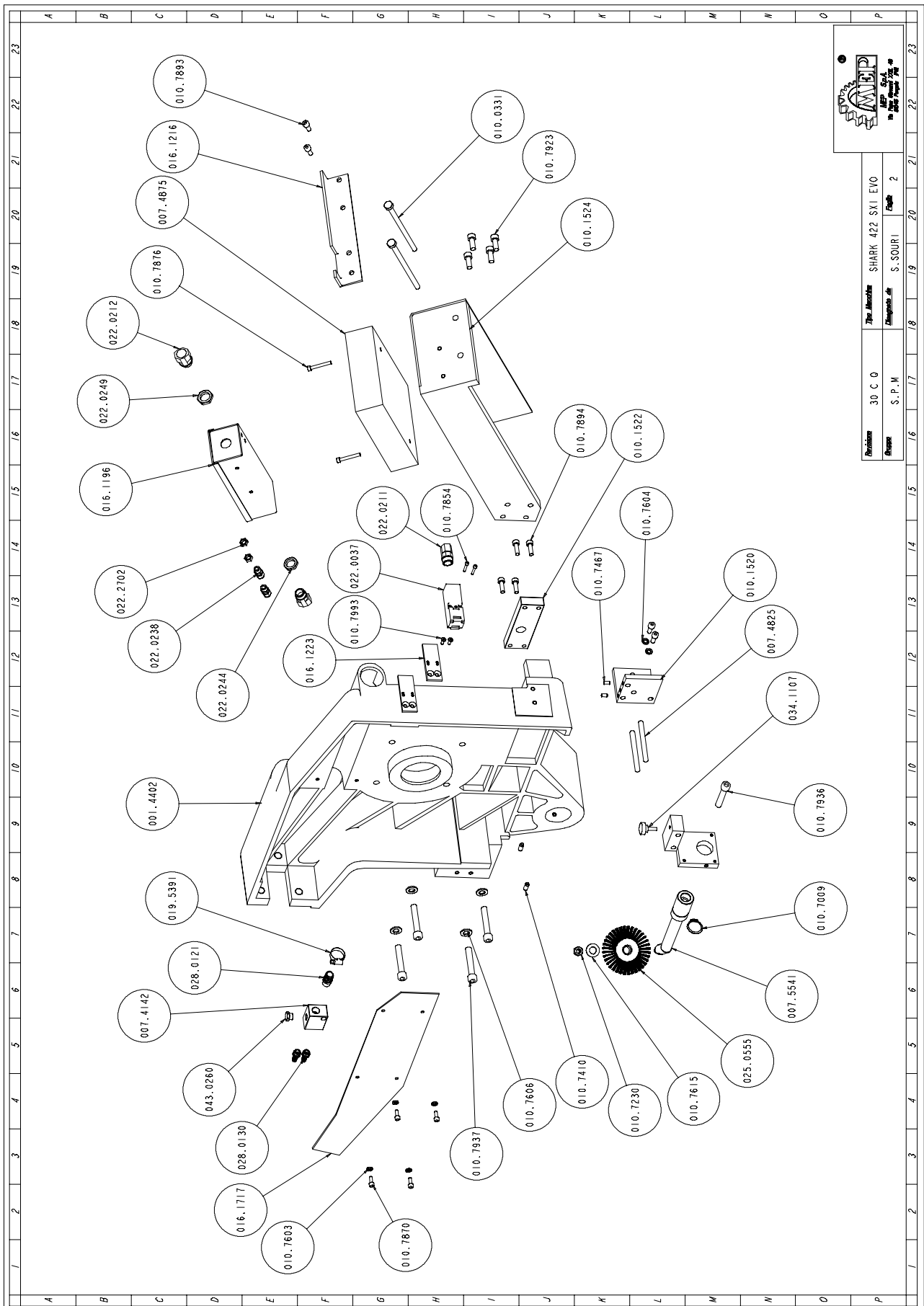

		Revision	30 C Q	Titel	Motor	SHARK 422 SXI EVO	Bladz.	2
		Revisie	S.P.M	Aanpak	de	S. SOURI	Bladz.	2

Art. NR.	Benaming	M.	Hoeveelheid
001.4402	SPM-TI-REX400.PRT	NR	1
007.4142	SQUADRETTO-LIQUIDO-SH320-330.PRT	NR	1
007.4825	PERNO-DI-SCOR-MOTORE-PULI-SH400.PRT	NR	2
007.4875	PIASTRA-BILANCIATRICE-SH400.PRT	NR	1
007.5541	ALBERO-PORT-PULILAMA-SH420-SXI.ASM	NR	1
010.0331	VITE-MOLLA-SNODO-TESTA-SH400.PRT	NR	2
010.1520	STAFFA-REG-SPAZZOLA-MOTOR-SH400.PRT	NR	1
010.1522	STAFFA-ESTERNA-CILINDRO-SH400.PRT	NR	1
010.1524	STAFFA-AGG-DOP-MOLLA-SPM-SH400.ASM	NR	1
010.7009	SEEGER-30.PRT	NR	1
010.7230	DADO-AUTOB-M10.PRT	NR	1
010.7410	M8X16-VCEI-PR.PRT	NR	2
010.7467	M6X12-VCEI-P.PRT	NR	2
010.7603	ROSETTA-6_4X12_5.PRT	NR	4
010.7604	ROSETTA-8_4X14.PRT	NR	2
010.7606	ROSETTA-13X24.PRT	NR	4
010.7615	ROSETTA-15X28.PRT	NR	1
010.7854	M4X25-TCEI.PRT	NR	2
010.7870	M6X16-TCEI.PRT	NR	4
010.7876	M6X45-TCEI.PRT	NR	2
010.7893	M8X20-TCEI.PRT	NR	4
010.7894	M8X25-TCEI.PRT	NR	4
010.7923	M10X25-TCEI.PRT	NR	4
010.7936	M12X65-TCEI.PRT	NR	1
010.7937	M12X70-TCEI.PRT	NR	4
010.7993	M5X12-TSPEI.PRT	NR	2
016.1196	SCATOLA-DERIV-SHSXINT.ASM	NR	1
016.1216	STAFFA-FIX-GUAINA-SH420.PRT	NR	1
016.1223	016_1223.PRT	NR	2
016.1717	PROTEZIONE-CAVI-SPM-SH400.PRT	NR	1
019.5391	FASCETTA-MINUS-GT-16X25.PRT	NR	1
022.0037	022_0037.PRT	NR	1
022.0211	PG-13_5-KIEPE.PRT	NR	2
022.0212	PG-16-KIEPE.PRT	NR	1
022.0238	PRESSACAVO-PG7-BS01.PRT	NR	2
022.0244	DADO-PASSACAVO-PG13_5.PRT	NR	1
022.0249	DADO-PASSACAVO-PG16.PRT	NR	1
022.2702	DADO-PG7-BL01.PRT	NR	2
025.0555	SPAZ-PULILAMA-3103-0-100-SH400.PRT	NR	1
028.0121	RACCORDO-3_8-17CL2601.PRT	NR	1
028.0130	RACCORDO-1_4-9_CL2601.PRT	NR	2
034.1107	VOLANTINO-DIAM30M6X20.PRT	NR	1
043.0260	TAPPO-TTE4-1_4-CL2611.PRT	NR	1

Achterste-zaagbandgeleideblokje groep

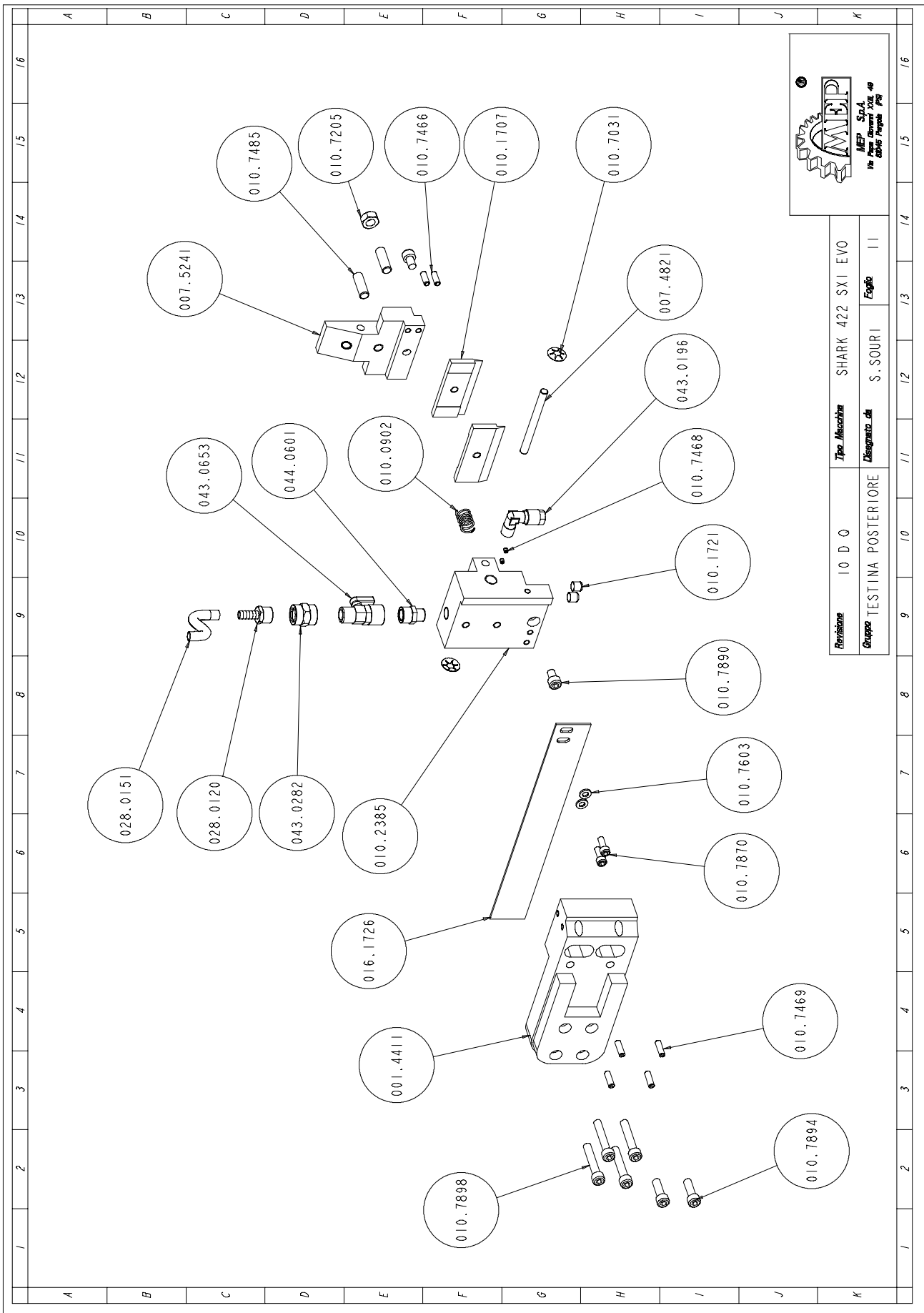

Art. NR.	Benaming	M.	Hoeveelheid
001.4411	STAFFA-TESTINA-POST-SH400.PRT	NR	1
007.4821	PERNO-SNODO-TESTINA-SH400.PRT	NR	1
007.5241	TES-GUID-POST-MOBILE-SH400-NT.PRT	NR	1
010.0902	MOLLA-PFISSO.PRT	NR	1
010.1719	GUIDALAMA-SH400.PRT	NR	2
010.1721	BOTTONE.PRT	NR	2
010.2385	TES-GUID-POST-FISSA-SH400.PRT	NR	1
010.7031	ANELLO-SEEGER-SK8.PRT	NR	2
010.7205	DADO-M10.PRT	NR	1
010.7466	M6X16-VCEI-P.PRT	NR	2
010.7468	M4X4-VCEI-P.PRT	NR	2
010.7469	M6X20-VCEI-P.PRT	NR	4
010.7485	M10X30-VCEI-P.PRT	NR	2
010.7603	ROSETTA-6_4X12_5.PRT	NR	2
010.7870	M6X16-TCEI.PRT	NR	2
010.7890	M8X12-TCEI.PRT	NR	2
010.7894	M8X25-TCEI.PRT	NR	2
010.7898	M8X45-TCEI.PRT	NR	4
016.1726	PROT-LAMA-POST-SH400.PRT	NR	1
028.0120	RACCORDO-3_8-9_CL2601.PRT	NR	1
028.0151	TUBO-PLASTIFICATO-07-11.PRT	NR	1
043.0196	RACCORDO-GOMITO-MF8X1_4CL1020.PRT	NR	1
043.0282	MANICOTTO-3_8.PRT	NR	1
043.0653	RUBINETTO-MF-3_8-CL6310.PRT	NR	1
044.0601	RIDUZIONE-MMRC-3_8-1_4.PRT	NR	1

Motor groep

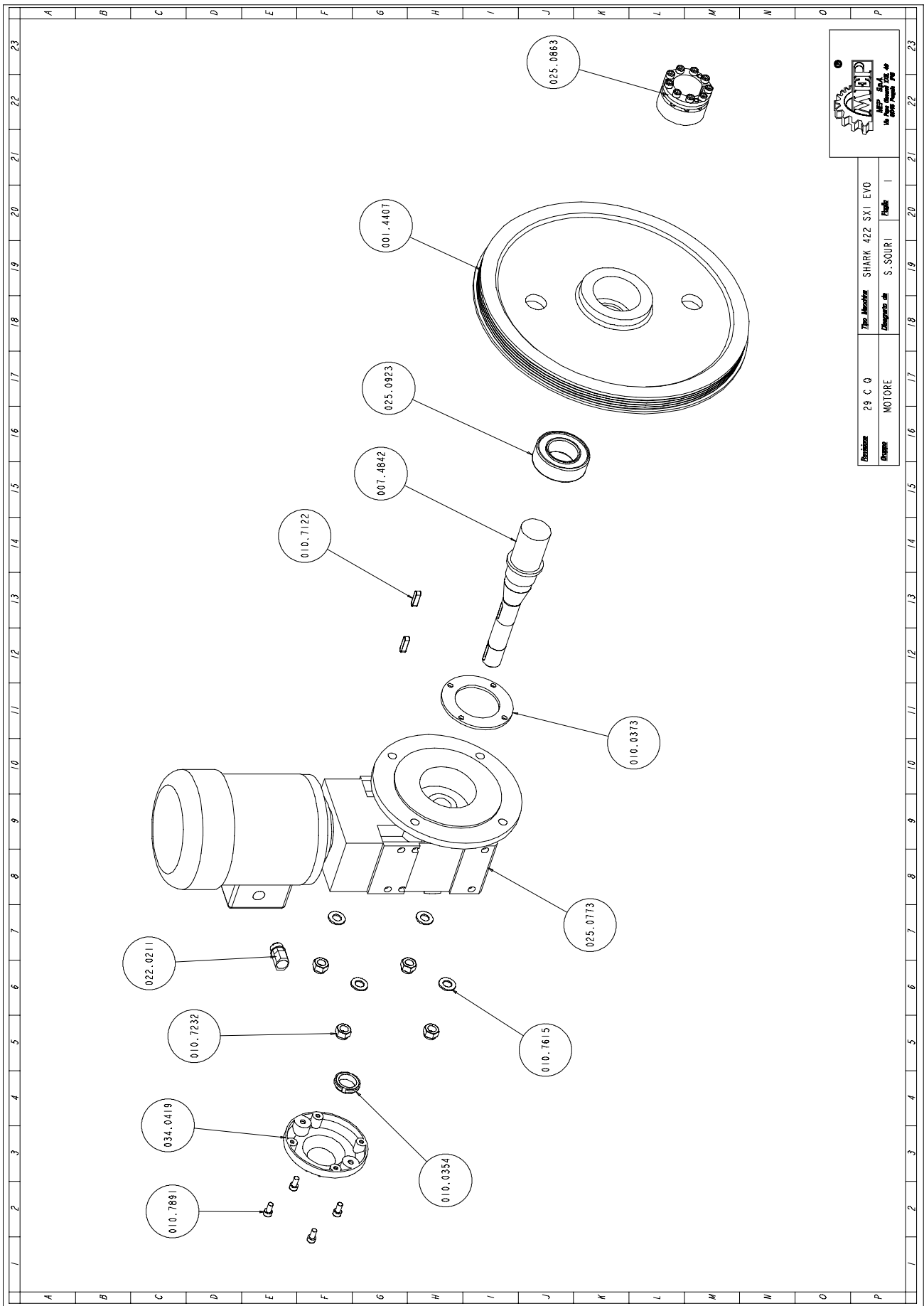

Art. NR.	Benaming	M.	Hoeveelheid
001.4407	PULEGGIA-MOTRICE-SH400.PRT	NR	1
007.4842	ALBERO-RIDUTTORE-SHARK420.PRT	NR	1
010.0354	GHIERA-30-15.PRT	NR	1
010.0373	GHIERA-FIX-CUSCINETTO-RID-SH400.PRT	NR	1
010.7122	LINGUETTA-A8X8X32.PRT	NR	2
010.7232	DADO-AUTOB-M14.PRT	NR	4
010.7615	ROSETTA-15X28.PRT	NR	4
010.7891	M8X16-TCEI.PRT	NR	4
010.7895	M8X30-TCEI.PRT	NR	9
022.0211	PG-13 5-KIEPE.PRT	NR	1
025.0773	MOTORID-A202F1C53_7S3.PRT	NR	1
025.0863	CALETTATORE-TLK130-50X80.ASM	NR	1
025.0923	3210E-2RS1.PRT	NR	1
034.0419	COPERCHIO-RIDUTTORE-2.PRT	NR	1

Dwarsbalk groep

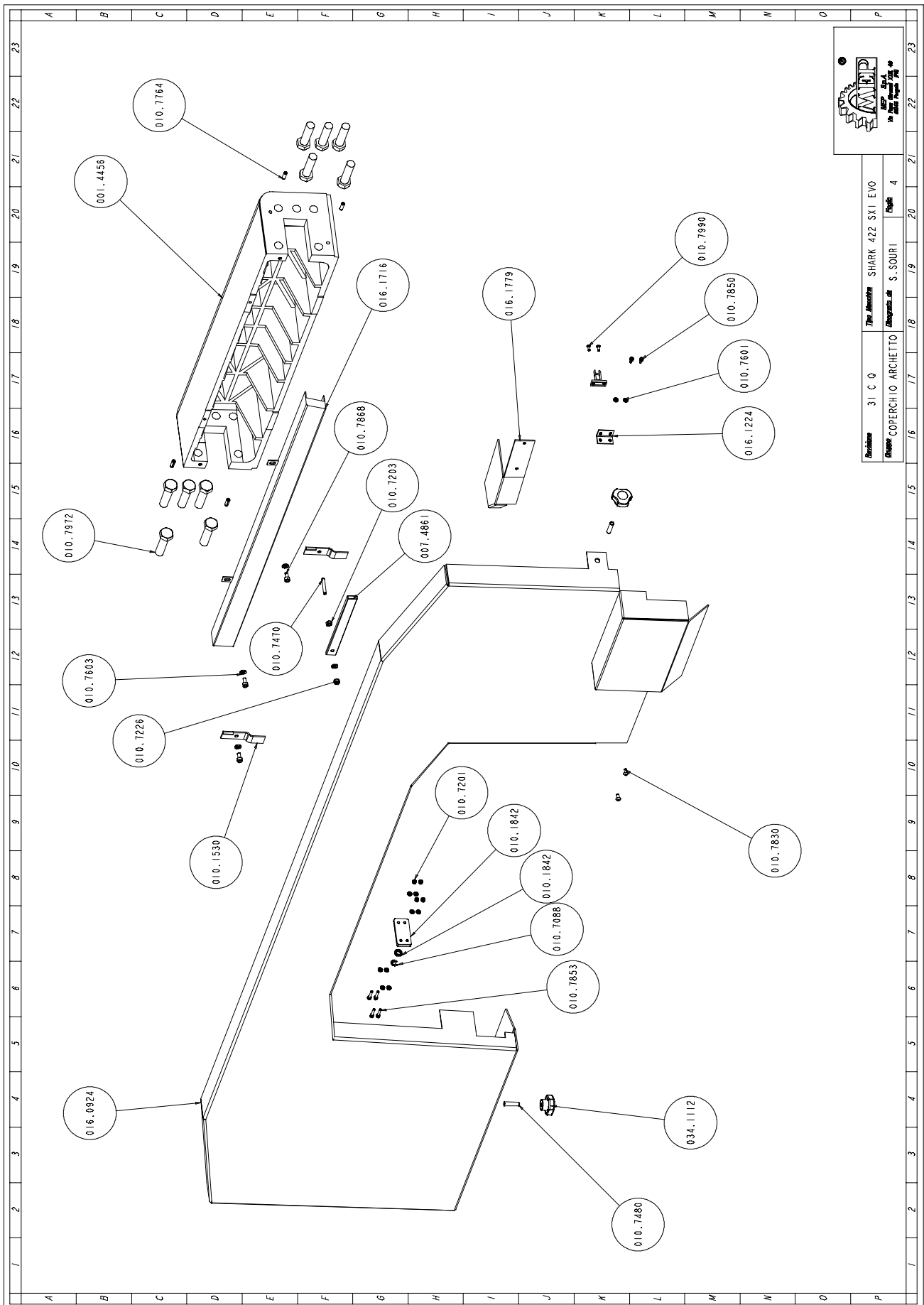

Art. NR.	Benaming	M.	Hoeveelheid
001.4456	TRAVE-ARCHETTO-SH420.PRT	NR	1
007.4861	SOSTEGNO-COPERCHIO-ARCHET-SH400.PRT	NR	1
010.1530	STAFFA-DI-FERMO-SH400.PRT	NR	2
010.1842	SUP-MASCHIO-X-MOLLA-A-GAS-DIST.PRT	NR	1
010.1842	SUPPORTO-MASCHIO-X-MOLLA-A-GAS.PRT	NR	1
010.7088	ANELLO-ELA-ESP-7.PRT	NR	1
010.7201	DADO-M4.PRT	NR	4
010.7203	DADO-M6.PRT	NR	1
010.7226	DADO-AUTOB-M6.PRT	NR	1
010.7470	M6X35-VCEI-P.PRT	NR	1
010.7480	M8X30-VCEI-P.PRT	NR	2
010.7601	ROSETTA-4_1X9.PRT	NR	0
010.7603	ROSETTA-6_4X12_5.PRT	NR	4
010.7764	SPINA-ELASTICA-6X20.PRT	NR	4
010.7830	M5X10-BUTTO.PRT	NR	2
010.7850	M4X8-TCEI.PRT	NR	2
010.7853	M4X20-TCEI.PRT	NR	4
010.7868	M6X12-TCEI.PRT	NR	3
010.7972	M16X60-TE.PRT	NR	0
010.7990	M4X8-TSPEI.PRT	NR	2
016.0924	COPERCHIO-ARCHETTO-SH420.ASM	NR	1
016.1224	PIASTRA-FISS-INTERR-COP-SH.PRT	NR	1
016.1716	PROTEZIONE-CAVI-TRAVE-SH400.PRT	NR	1
016.1779	PROT-LAMA-POST-SH400-NT.PRT	NR	1
034.1112	VOLANTINO-DIA_40M8XPIED_SH-CO33.PRT	NR	2

Doorsnede-loopwiel groep

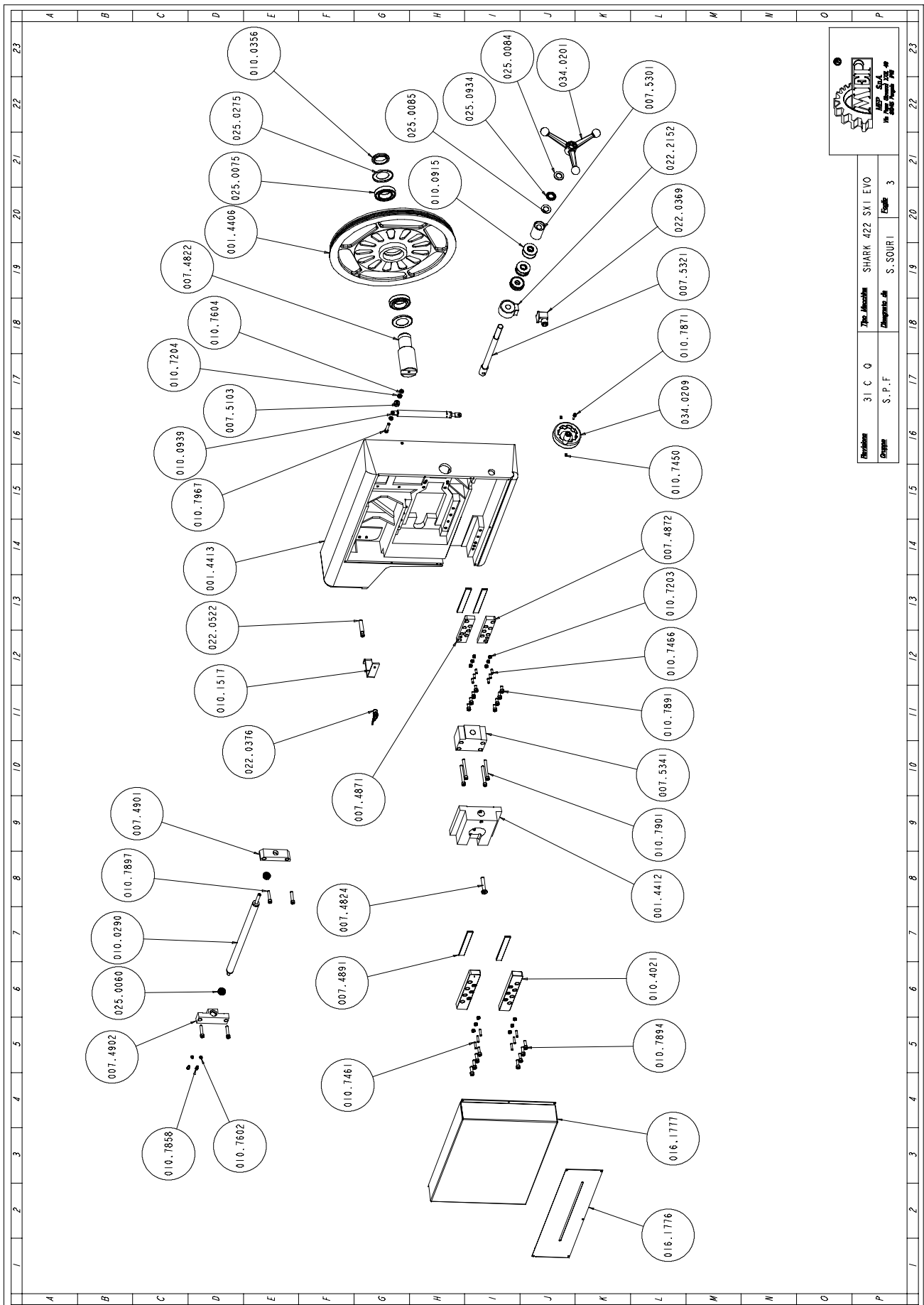

Revisie	31 C 0	The Machine	SHARK 422 SXI EVO
Opzet	S.P.F.	Maatschappij	S.SOURI
		Scale	3

Art. NR.	Benaming	M.	Hoeveelheid
001.4412	SLITTA-TENDILAMA-SH400.PRT	NR	1
001.4406	PULEGGIA-FOLLE-SHARK400.PRT	NR	1
001.4413	SPF-SH422.PRT	NR	1
007.4822	PERNO-PULEGGIA-FOLLE-SH400.PRT	NR	1
007.4824	PERNO-BLOCC-CIL-TENS-LAMA-TR400.PRT	NR	1
007.4871	PIA-SUP-REG-LARD-SUP-TEST-SH400.PRT	NR	1
007.4872	PIA-INF-REG-LARD-SUP-TEST-SH400.PRT	NR	1
007.4891	LARD-SLIT-TEN-E-SUP-TEST-SH400.PRT	NR	4
007.4901	SUPP-POS-X-VITE-TRAS-TEST-SH400.PRT	NR	1
007.4902	SUPP-ANT-X-VITE-TRAS-TEST-SH400.PRT	NR	1
007.5103	DISTANZIALE-MOLLA-A-GAS-SH400.PRT	NR	1
007.5301	DISTANZ-TENSION-LAMA-SH420SXI.PRT	NR	1
007.5321	PERNO-TENSIONAM-LAMA-SH420SXI.PRT	NR	1
007.5341	SUPPORTO-TENS-LAMA-SH420SXI.PRT	NR	1
010.0290	VITE-SUP-TEST-GUID-SH420SXI.PRT	NR	1
010.0356	GHIERA-45-15.PRT	NR	1
010.0915	MOLLA-A-TAZZA-18-50-3.PRT	NR	6
010.0939	MOLLA-A-GAS300MM300N-SH400.PRT	NR	1
010.1517	STAFFA-FIX-PROXIMITY-SH400.PRT	NR	1
010.4021	PIAS-REG-SLITTA-LARDONE-SH320.PRT	NR	2
010.7203	DADO-M6.PRT	NR	2
010.7204	DADO-M8.PRT	NR	1
010.7450	M6X6-VCEI-PC.PRT	NR	2
010.7461	M6X25-VCEI-P.PRT	NR	6
010.7466	M6X16-VCEI-P.PRT	NR	6
010.7602	ROSETTA-5_3X10.PRT	NR	2
010.7604	ROSETTA-8_4X14.PRT	NR	2
010.7858	M5X10-TCEI.PRT	NR	2
010.7871	M6X20-TCEI.PRT	NR	1
010.7891	M8X16-TCEI.PRT	NR	8
010.7894	M8X25-TCEI.PRT	NR	8
010.7897	M8X40-TCEI.PRT	NR	4
010.7901	M8X75-TCEI.PRT	NR	4
010.7967	M8X40-TE.PRT	NR	1
016.1776	PROT-INF-SPF-SH422.PRT	NR	1
016.1777	PROT-SUP-SPF-SH422.PRT	NR	1
022.0369	TENSIONATORE-ELETTRON-COMP2.PRT	NR	1
022.0376	CONNETTORE-F303N5000XPROSSIMITI.PRT	NR	1
022.0522	PROXIMITY.PRT	NR	1
022.2152	TENSIONATORE-ELETTRON-COMP1.PRT	NR	1
025.0060	6000-2Z.PRT	NR	2
025.0075	32009X.PRT	NR	2
025.0084	RALLA-GS-81104.PRT	NR	1
025.0085	RALLA-WS-81104.PRT	NR	1
025.0275	NILOS-32009X.PRT	NR	2
025.0934	REGGISPINTA-K81104.PRT	NR	1
034.0201	VOLANTINO-MORSA-GRANDE.PRT	NR	1
034.0209	VOL-MORSA-D100-FORATO.PRT	NR	1

Voorste-geleideblokje groep

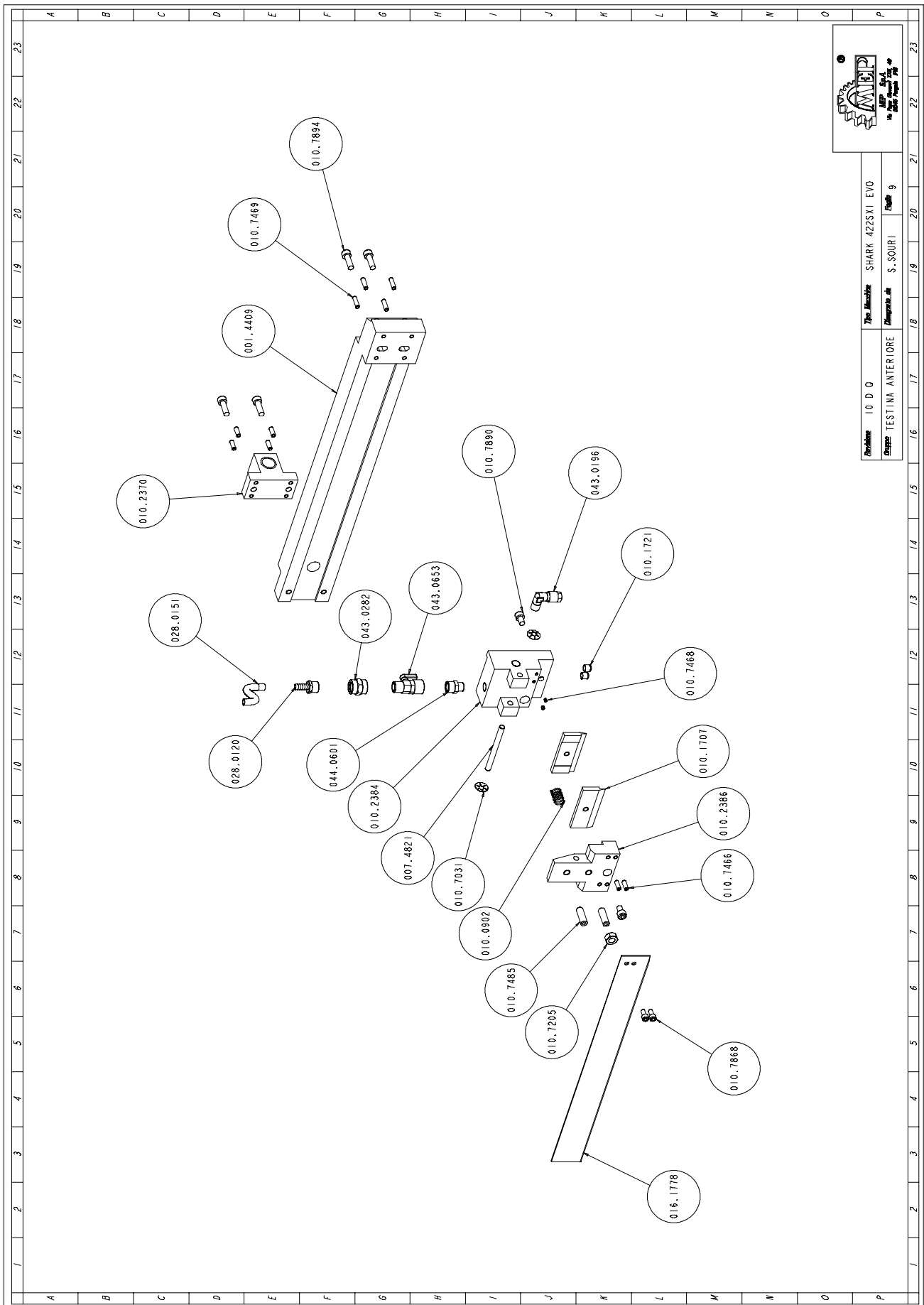

Revisie	10 D 0	Type Machine	SHARK 422 SXI EVO
Grp	TESTINA ANTERIORE	Monteur	S. SOURI
		Blade	9

Art. NR.	Benaming	M.	Hoeveelheid
001.4409	STAFFA-SUPP-TESTINA-ANT-SH400.PRT	NR	1
007.4821	PERNO-SNODO-TESTINA-SH400.PRT	NR	1
010.0902	MOLLA-PFISSO.PRT	NR	1
010.1707	GUIDALAMA-SH400.PRT	NR	2
010.1721	BOTTONE.PRT	NR	2
010.2370	CHIOC-SLITTA-TEST-GUID-SH400.PRT	NR	1
010.2384	TESTINA-GUID-ANT-FISSA-SH400.PRT	NR	1
010.2386	TETSINA-GUID-ANT-MOBILE-SH400.PRT	NR	1
010.7031	ANELLO-SEEGER-SK8.PRT	NR	2
010.7205	DADO-M10.PRT	NR	1
010.7466	M6X16-VCEI-P.PRT	NR	6
010.7468	M4X4-VCEI-P.PRT	NR	2
010.7469	M6X20-VCEI-P.PRT	NR	4
010.7485	M10X30-VCEI-P.PRT	NR	2
010.7868	M6X12-TCEI.PRT	NR	2
010.7890	M8X12-TCEI.PRT	NR	2
010.7894	M8X25-TCEI.PRT	NR	4
016.1778	PROT-LAMA-ANT-SH400-NT.PRT	NR	1
028.0120	RACCORDO-3_8-9_CL2601.PRT	NR	1
028.0151	TUBO-PLASTIFICATO-07-11.PRT	NR	1
043.0196	RACCORDO-GOMITO-MF8X1_4CL1020.PRT	NR	1
043.0282	MANICOTTO-3_8.PRT	NR	1
043.0653	RUBINETTO-MF-3_8-CL6310.PRT	NR	1
044.0601	RIDUZIONE-MMRC-3_8-1_4.PRT	NR	1

Cilindergroep

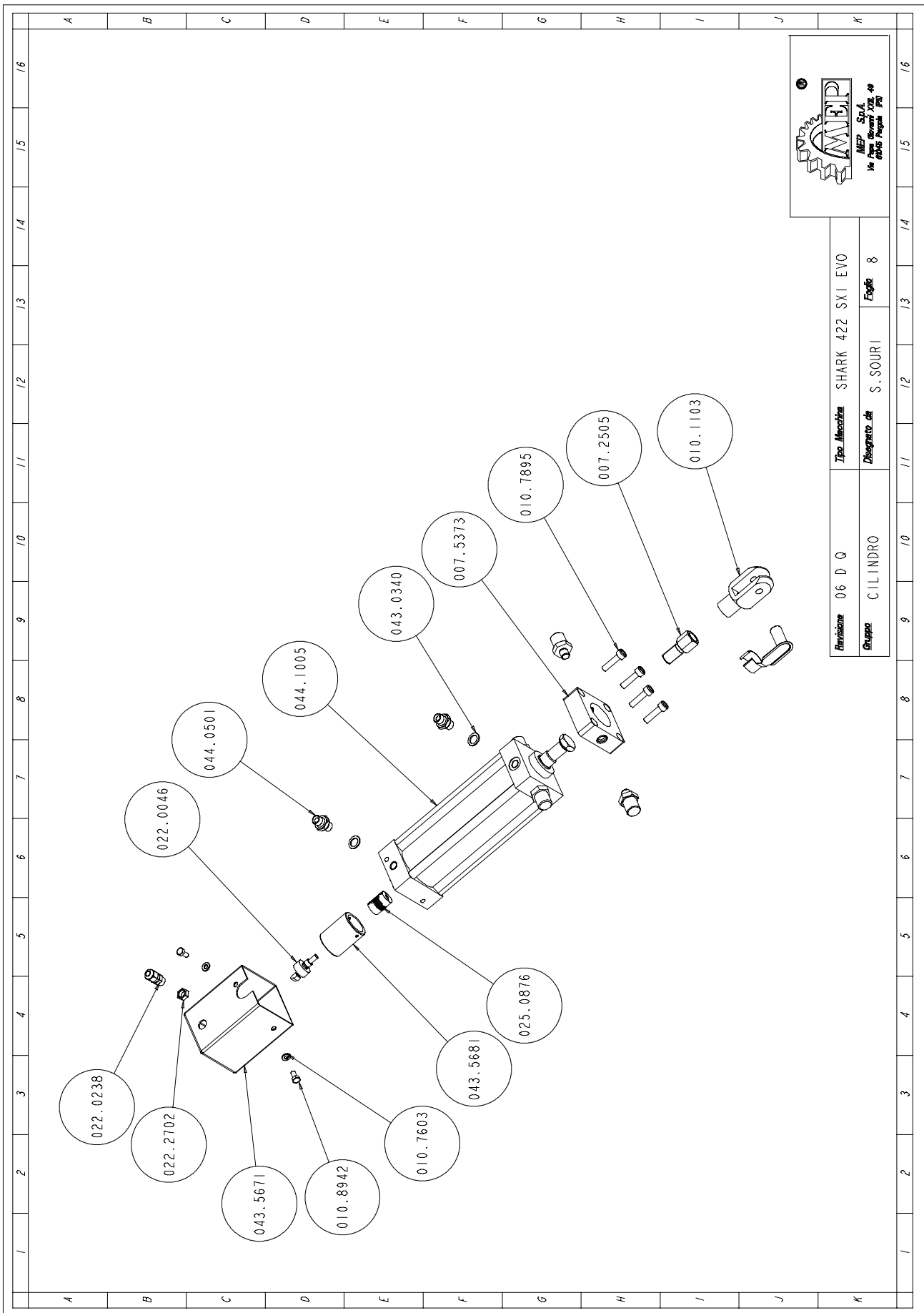

Art. NR.	Benaming	M.	Hoeveelheid
007.2505	PROLUNGA-FORCELLA.PRT	NR	1
007.5373	PROLUNGA-TEST-ANT-CIL-SH420SXI.ASM	NR	1
010.1103	FORCELLA-16X1.PRT	NR	1
010.7603	ROSETTA-6_4X12_5.PRT	NR	2
010.7895	M8X30-TCEI.PRT	NR	4
010.8942	M6X12-TE.PRT	NR	2
022.0046	POTENZIOMETRO-6693S001-202-SHSX.PRT	NR	1
022.0238	PRESSACAVO-PG7-BS01.PRT	NR	1
022.2702	DADO-PG7-BL01.PRT	NR	1
025.0876	GIUNTO-W-A-6-6MM28.PRT	NR	1
043.0340	RONDELLA-RAME-1_4.PRT	NR	2
043.5671	PROTEZIONE-POT-CILINDRO.PRT	NR	1
043.5681	SUPPORTO-POTENZIOMETRO-CILINDRO.PRT	NR	1
044.0501	NIPPLO-NP-1_4-IDRAULICO.PRT	NR	2
044.1005	CILINDRO-IDRUL63-150MMSH280-320.ASM	NR	1

Hydraulische aggregaten

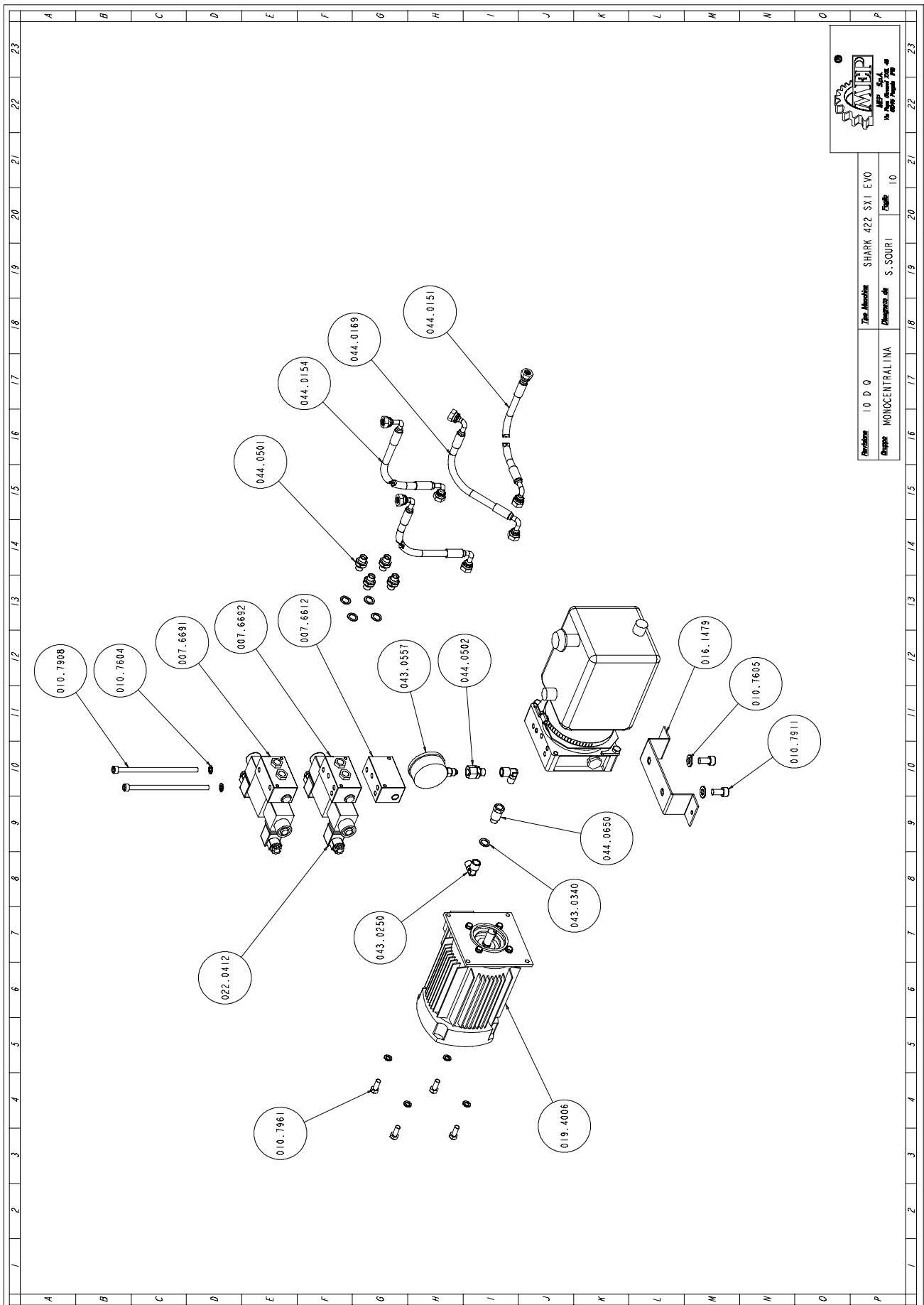

Art. NR.	Benaming	M.	Hoeveelheid
007.6612	DIST-PANNELLO-IDRAULICO.PRT	NR	1
007.6691	PANNELLO-IDR-TERMINALE.PRT	NR	1
007.6692	PANNELLO-IDR-CENTRALE.PRT	NR	1
010.7603	ROSETTA-6_4X12_5.PRT	NR	4
010.7604	ROSETTA-8_4X14.PRT	NR	6
010.7605	ROSETTA-10_5X21.PRT	NR	2
010.7875	M6X40-TCEI.PRT	NR	4
010.7886	M5X35-TCEI.PRT	NR	8
010.7908	M8X160-TCEI.PRT	NR	2
010.7908	M8X50-TCEI.PRT	NR	4
010.7911	M10X20-TCEI.PRT	NR	2
010.7951	M6X20-TE.PRT	NR	4
010.7961	M8X20-TE.PRT	NR	6
010.8343	LINGUETTA-A5X5X20.PRT	NR	1
016.1479	STAFFA-ANCOR-MONOCENTRALINA.PRT	NR	1
016.1479	STAFFA-SERBATOIO.PRT	NR	2
019.4006	MOTORE-CENTRALINA-HP05C71B14.PRT	NR	1
022.0412	CONN-X-BOB-VAL-RIG-SH310SXI-AXI.PRT	NR	4
025.0208	ANELLO-OR-109.PRT	NR	4
043.0227	RIDUZIONE-MF-1_4-3_8-CL2531.PRT	NR	4
043.0250	GOMITO-MF1_4CL2020.PRT	NR	2
043.0261	TAPPO-TTE8-1_8-CL2611.PRT	NR	2
043.0340	RONDELLA-RAME-1_4.PRT	NR	7
043.0557	MANOMETRO-0-60-WIKA.PRT	NR	1
044.0151	TUBO-CENT3500MM-1X90SH320AXI.PRT	NR	1
044.0154	TUBO-CENT-MM3500-2X90SH320CNC.PRT	NR	2
044.0169	TUBO-IDR-MM6000-GG.PRT	NR	1
044.0501	NIPPLO-NP-1_4-IDRAULICO.PRT	NR	4
044.0502	NIPPLO-IDRAULICO-GIR-GMF-1_4.PRT	NR	1
044.0650	PROLUNGA-1_4MF-ES36MM.PRT	NR	1

Rollenbanen

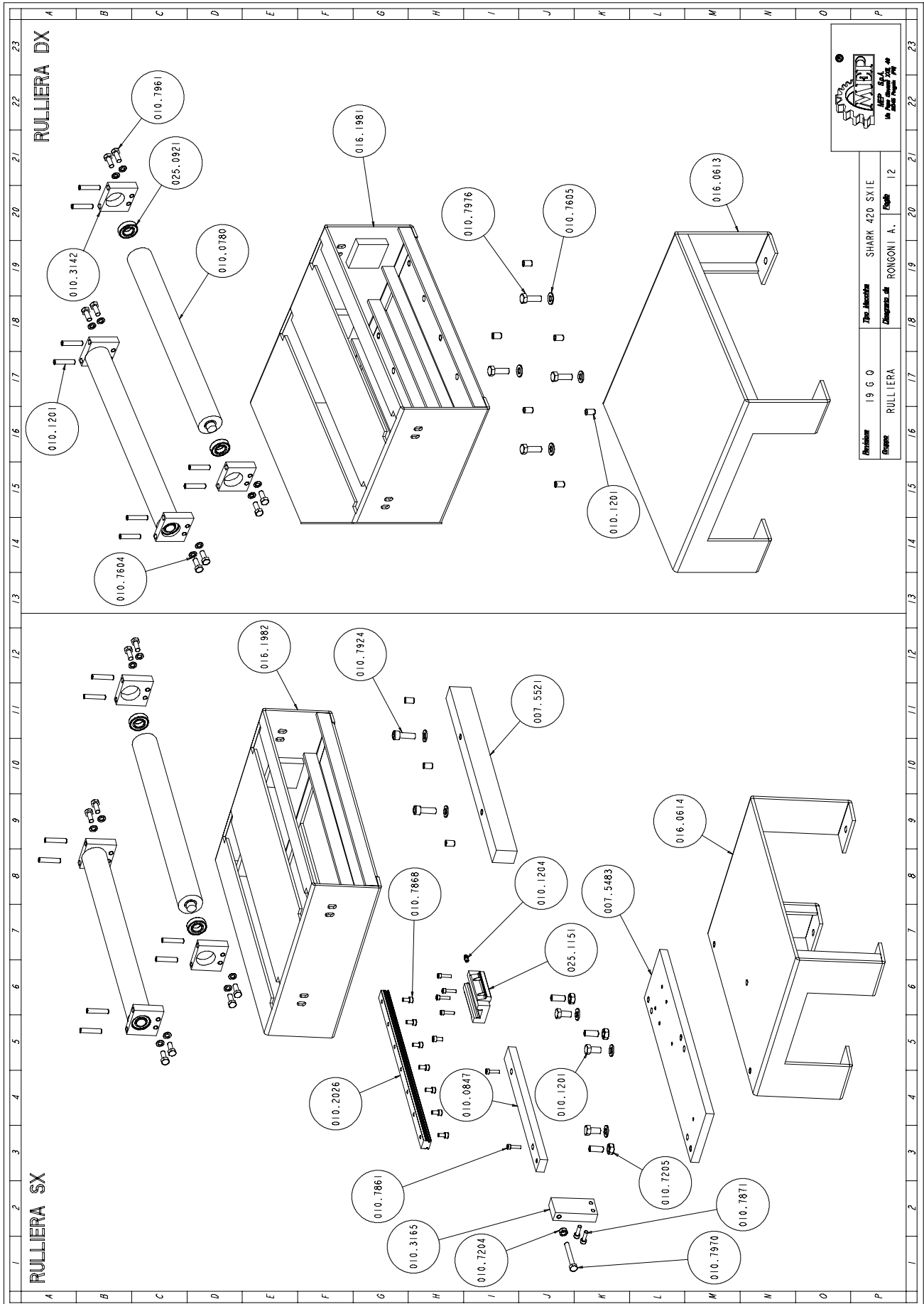

Art. NR.	Benaming	M.	Hoeveelheid
007.5483	PIASTRA FISSAGGIO RULLIERA SINISTRA	NR	1,000
007.5521	APPOGGIO REGOLABILE PER RULLIERA	NR	1,000
010.0780	RULLO 0 45 X RULLIERA SH 420 SXI	NR	1,000
010.0847	SUPPORTO GUIDA PATTINO DX-SX SH 420	NR	1,000
010.1201	VITERIA E BULLONERIA	NR	17,000
010.1204	INGRASSATORE M 6	NR	1,000
010.2026	GUIDA PATTINO LGR20 MT.0,400 PER	NR	1,000
010.3142	SUPPORTO X RULLO 0 45 RULLIERA SH	NR	2,000
010.3165	BATTUTA X RULLIERA DX-SX SH 420 SE	NR	1,000
010.7204	DADO M8	NR	1,000
010.7205	DADO M10	NR	3,000
010.7604	RONDELLA DIAM. 8	NR	8,000
010.7605	RONDELLA DIAM. 10	NR	5,000
010.7861	VITE TCEI 5 X 20	NR	6,000
010.7868	VITE TCEI 6 X 12	NR	7,000
010.7871	VITE TCEI 6 X 20	NR	2,000
010.7924	VITE TCEI 10 X 30	NR	2,000
010.7961	VITE TE 8 X 20	NR	8,000
010.7970	VITE TE 8 X 60	NR	1,000
016.0614	SUPPORTO X RULLIERA SX SH 420 SE	NR	1,000
016.1982	CORPO RULLIERA SINISTRA SH 420 SXI	NR	1,000
025.0921	CUSCINETTO 6003 2Z	NR	2,000
025.1151	PATTINO LGW20HAZ1C	NR	1,000
090.2504	RULLIERA APPOGGIA BARRA SINISTRA	NR	1,000

Art. NR.	Benaming	M.	Hoeveelheid
010.1201	VITERIA E BULLONERIA	NR	14,000
010.7604	RONDELLA DIAM. 8	NR	8,000
010.7605	RONDELLA DIAM. 10	NR	4,000
010.7961	VITE TE 8 X 20	NR	8,000
010.7976	VITE TE 10 X 30	NR	4,000
016.0613	SUPPORTO X RULLIERA DESTRA SH 420SE	NR	1,000
016.1981	CORPO RULLIERA DESTRA SH 420 SXI	NR	1,000
090.2503	RULLIERA APPOGGIA BARRA DESTRA	NR	1,000

Bedieningspaneel groep

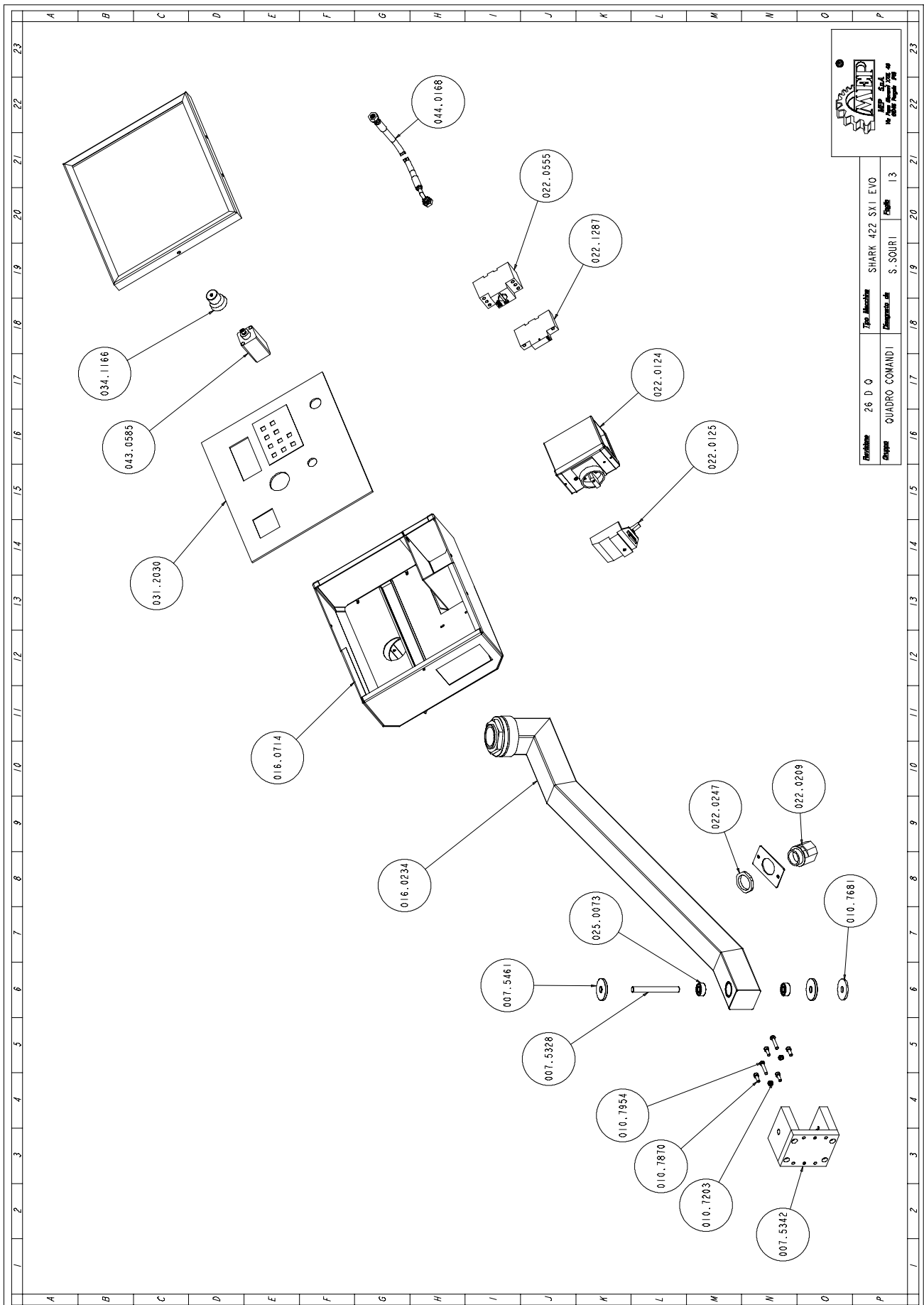

Art. NR.	Benaming	M.	Hoeveelheid
007.5328	PERNO-CUSC-ASTA-MOB-SH420.PRT	NR	1
007.5342	SUPPORTO-ASTA-MOBILE-SH420.ASM	NR	1
007.5461	ROSETTA-ASTA-MOBILE-SH420.PRT	NR	2
010.7203	DADO-M6.PRT	NR	2
010.7681	ROSETTA-13X48.PRT	NR	1
010.7870	M6X16-TCEI.PRT	NR	4
010.7954	M6X30-TE.PRT	NR	2
016.0234	ASTA-MOB-CONS-CON-GIUNTO-452.ASM	NR	1
016.0714	QUADRO-COMANDI-SH-SXI-NT.ASM	NR	1
022.0124	INTERRUTTORE-PKZ0-GR.ASM	NR	1
022.0125	BLOCCO-LUCCHETTO-SVB-PKZ0.ASM	NR	1
022.0209	PG-29-KIEPE.PRT	NR	1
022.0247	DADO-POLIAM-HUMMEL-262-2900-11.PRT	NR	1
022.0555	SGANCIATORE-U-PKZ0-V400.PRT	NR	1
022.1287	INTERRUTTORE-PKZM0-TERMICA.PRT	NR	1
025.0073	63001.PRT	NR	2
031.2030	QUACOM-SH-SXI-MOSTRINA.PRT	NR	1
034.1169	MANOPOLA-REG-MONOG.PRT	NR	1
043.0594	REGOLATORE-IDRA-MONOG.PRT	NR	1
044.0168	TUBO-IDR-MM7800-DG.PRT	NR	1