

## Explosietekeningen

In het nu volgende deel zijn de explosietekeningen van de machine opgenomen. De tekeningen met hun volledige details kunnen helpen de machine beter te leren kennen.

### Assemblage frame hoofddeel

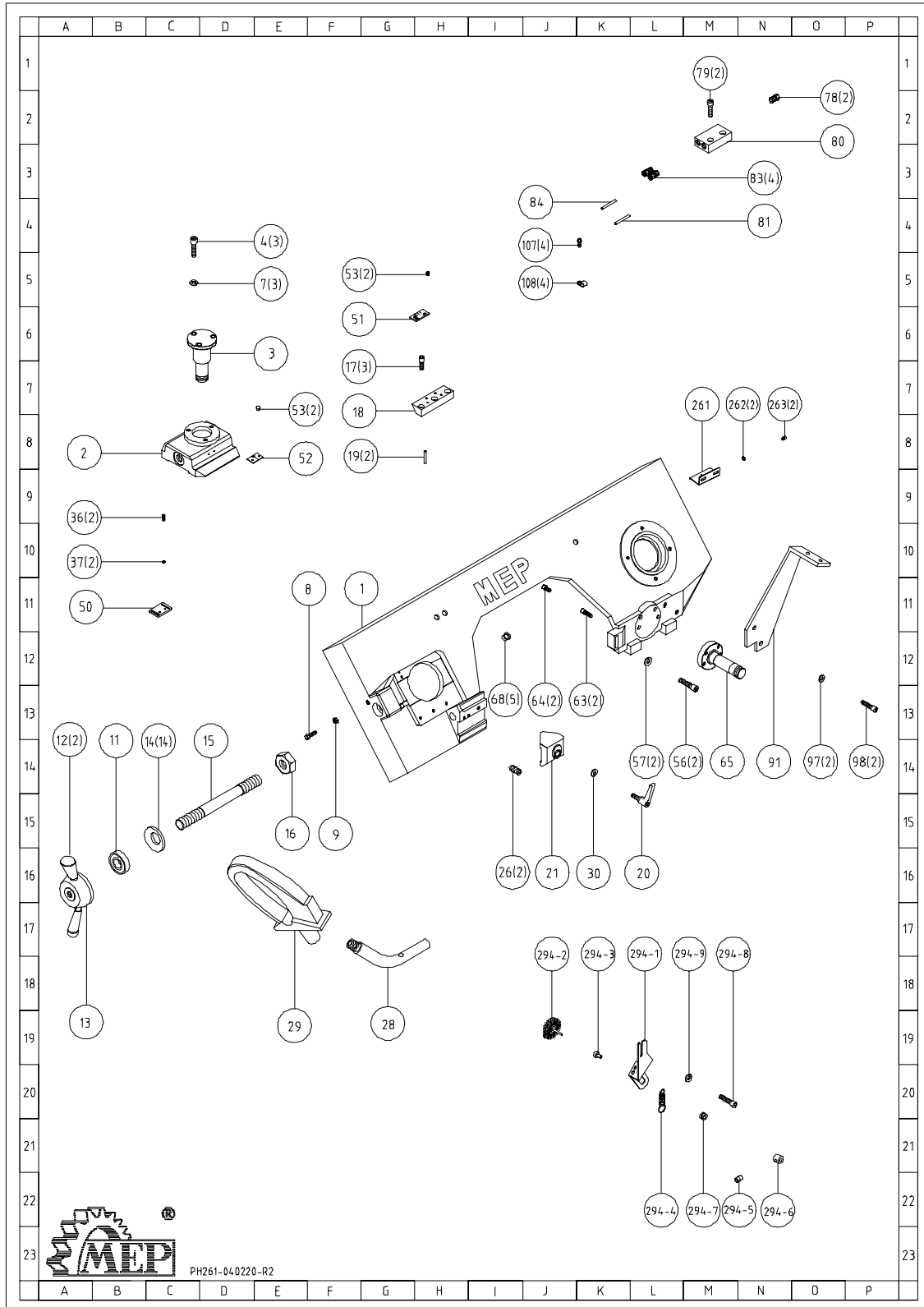

| NR.   | Art. NR. | Benaming                          | Hoeveelheid |
|-------|----------|-----------------------------------|-------------|
| 1     | 001.6004 | BODY FRAME                        | 1           |
| 2     | 001.6010 | ANCHOR BLOCK                      | 1           |
| 3     | 010.2137 | SHAFT                             | 1           |
| 4     | 010.1201 | HEX. SOCKET HEAD SCREW M8X30L     | 3           |
| 7     | 010.1201 | SPRING WASHER M8                  | 3           |
| 8     | 010.1201 | HEX. HEAD SCREW M8X45L            | 1           |
| 9     | 010.1201 | HEX. NUT M8                       | 1           |
| 11    | 025.0966 | BEARING 51202                     | 1           |
| 12    | 034.0291 | KNOB                              | 2           |
| 13    | 034.0291 | BLADE TENSION HANDLE              | 1           |
| 14    | 010.4064 | SPRING WASHER Ø 17X Ø 31.5X2.5    | 14          |
| 15    | 010.3706 | LEADSCREW                         | 1           |
| 16    | 010.1201 | HEX. NUT M16XP2                   | 1           |
| 17    | 010.1201 | HEX. SOCKET HEAD SCREW M8X25L     | 3           |
| 18    | 010.4025 | FIXED BLOCK                       | 1           |
| 19    | 010.1201 | PIN Ø 5X40                        | 2           |
| 20    | 034.1002 | GRIP M10X52L                      | 1           |
| 21    | 010.1588 | FIXED BLOCK                       | 1           |
| 26    | 010.1201 | HEX. SOCKET HEADLESS SCREW M8X10L | 2           |
| 28    | 010.1920 | CONNECTING TUBE                   | 1           |
| 29    | 090.0271 | HANDLE ASSEMBLY                   | 1           |
| 30    | 010.1201 | WASHER M10                        | 1           |
| 36    | 010.1201 | ROUND HEAD SCREW M5X15L           | 2           |
| 37    | 010.1201 | WASHER M5                         | 2           |
| 50    | 022.0515 | MICRO SWITCH BRACKET              | 1           |
| 51    | 031.2656 | SCALE                             | 1           |
| 52    | 031.2655 | SCALE                             | 1           |
| 53    | 010.1201 | RIVET Ø 2X6                       | 4           |
| 56    | 010.1201 | HEX. SOCKET HEAD SCREW M8X35L     | 2           |
| 57    | 010.1201 | WASHER M8                         | 2           |
| 63    | 010.1201 | HEX. SOCKET HEAD SCREW M10X40L    | 2           |
| 64    | 010.1201 | HEX. SOCKET HEAD SCREW M10X25L    | 2           |
| 65    | 010.3709 | FRAME PIVOT SHAFT                 | 1           |
| 68    | 022.0326 | PLASTIC BUSHING SB-16             | 5           |
| 78    | 028.0131 | HOSE FITTING Ø 8X1/4"PT           | 2           |
| 79    | 010.1201 | HEX. SOCKET HEAD SCREW M6X15L     | 2           |
| 80    | 010.2306 | 3 WAY VALVE                       | 1           |
| 81    | 028.0192 | PU TUBE Ø 6X240L                  | 1           |
| 83    | 028.0132 | HOSE FITTING Ø 6X1/8"PT           | 4           |
| 84    | 028.0191 | PU TUBE Ø 6X800L                  | 1           |
| 91    | 010.1589 | SPRING BRACKET                    | 1           |
| 97    | 010.1201 | SPRING WASHER M10                 | 2           |
| 98    | 010.1201 | HEX. SOCKET HEAD SCREW M10X25L    | 2           |
| 107   | 010.1201 | CROSS ROUND HEAD SCREW M5X20L     | 4           |
| 108   | 022.0392 | HOSE CLIP Ø 8                     | 4           |
| 261   | 016.1245 | POWER CUTTING BRACKET             | 1           |
| 262   | 010.1201 | WASHER M6                         | 2           |
| 263   | 010.1201 | HEX. SOCKET HEAD SCREW M6X12L     | 2           |
| 294-1 | 010.0869 | BRUSH SUPPORT                     | 1           |
| 294-2 | 025.0552 | BRUSH                             | 1           |
| 294-3 | 010.2068 | BUSHING                           | 1           |
| 294-4 | 010.4062 | SPRING                            | 1           |
| 294-5 | 010.1201 | HEX. SOCKER HEADLESS SCREW M6X10L | 1           |
| 294-6 | 010.2069 | BUSHING                           | 1           |
| 294-7 | 010.1698 | BEARING SPACER                    | 1           |
| 294-8 | 010.1201 | HEX. SOCKET HEAD SCREW M5X10L     | 1           |
| 294-9 | 010.1201 | WASHER M5                         | 1           |

### Assemblage van de motor

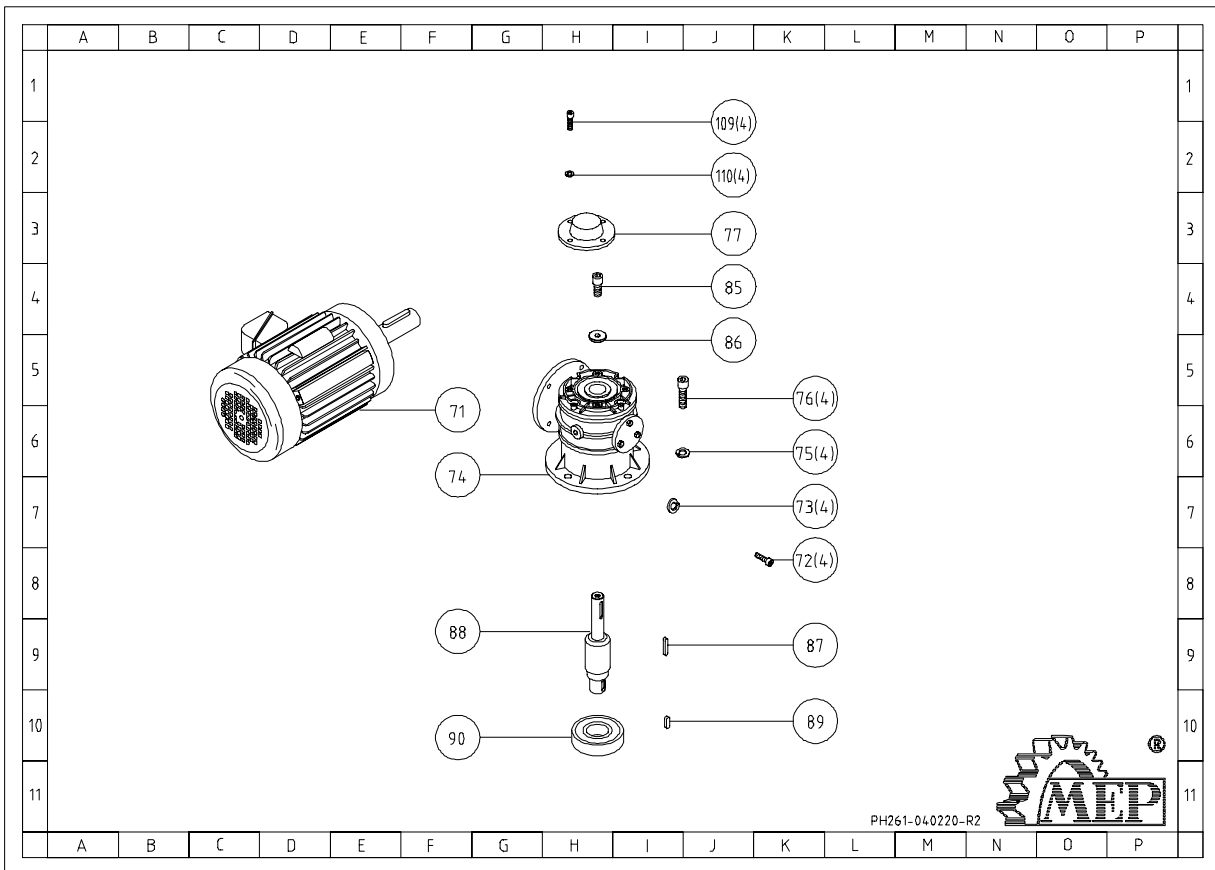

### Assemblage van de handgreep

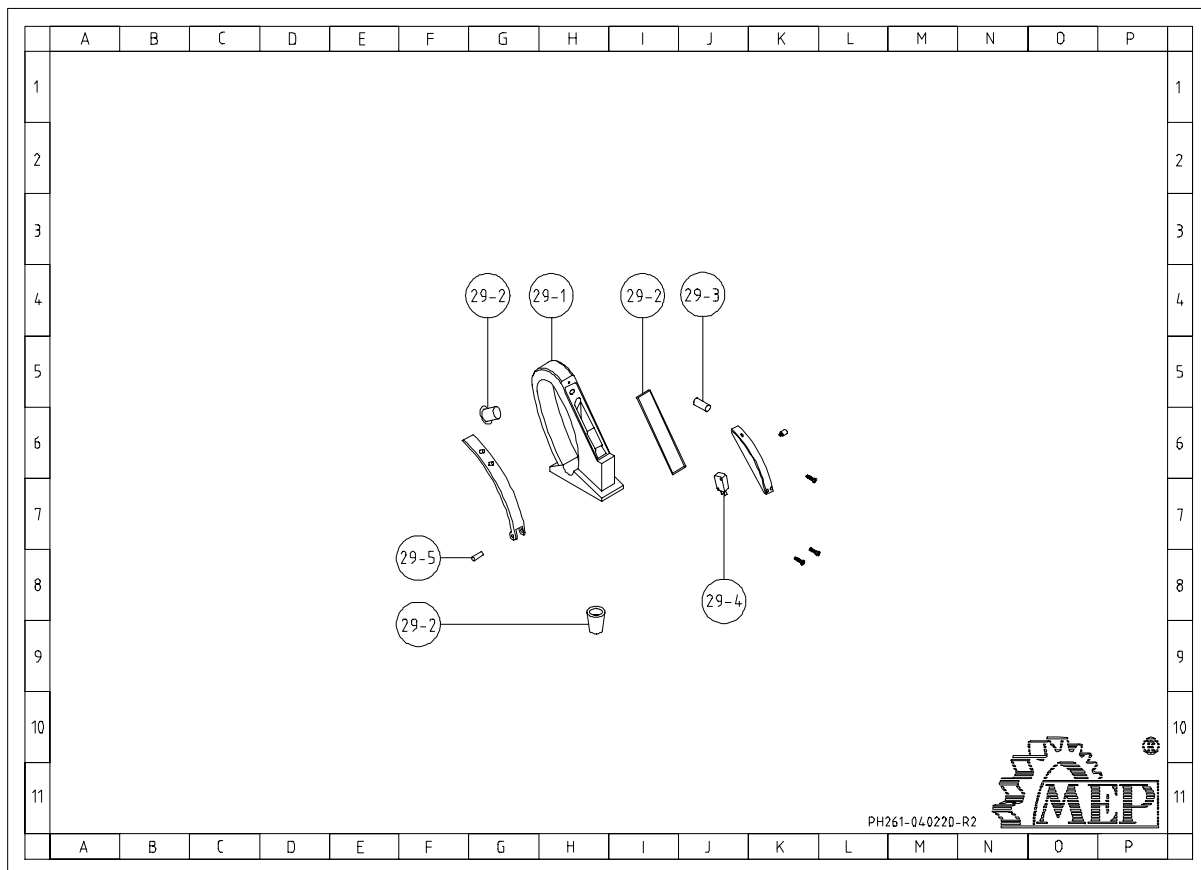

| <b>NR.</b> | <b>Art. NR.</b> | <b>Benaming</b>                     | <b>Hoeveelheid</b> |
|------------|-----------------|-------------------------------------|--------------------|
| 71         | 019.2341        | MOTOR (2/4P) 1HP/380V/50HZ/3PH/2/4P | 1                  |
| 72         | 010.1201        | HEX. SOCKET HEAD SCREW M6X25L       | 4                  |
| 73         | 010.1201        | SPRING WASHER M6                    | 4                  |
| 74         | 025.0769        | REDUCER 1:4                         | 1                  |
| 75         | 010.1201        | SPRING WASHER M10                   | 4                  |
| 76         | 010.1201        | HEX. SOCKET HEAD SCREW M10X30L      | 4                  |
| 77         | 034.0423        | REDUCER COVER                       | 1                  |
| 85         | 010.1201        | HEX. SOCKET HEAD SCREW M10X30L      | 1                  |
| 86         | 010.1201        | PRIVE SHAFT WASHER                  | 1                  |
| 87         | 010.1201        | ROUND HEAD KEY 8X7X50               | 1                  |
| 88         | 010.2138        | OUTPUT SHAFT                        | 1                  |
| 89         | 010.1201        | ROUND HEAD KEY 8X7X25               | 1                  |
| 90         | 025.0920        | BEARING 6208-2RS                    | 1                  |
| 109        | 010.1201        | HEX. SOCKET HEAD SCREW M8X15L       | 4                  |
| 110        | 010.1201        | SPRING WASHER M8                    | 4                  |

| <b>NR.</b> | <b>Art. NR.</b> | <b>Benaming</b> | <b>Hoeveelheid</b> |
|------------|-----------------|-----------------|--------------------|
| 29-1       | 090.0271        | HANDLE          | 1                  |
| 29-2       | 090.0271        | GASKET SERIES   | 1                  |
| 29-3       | 090.0271        | SPRING          | 1                  |
| 29-4       | 090.0271        | MICROSWITCH     | 1                  |
| 29-5       | 090.0271        | CYLINDRICAL PIN | 1                  |

### Assemblage instelbare zaagblad (achterkant)

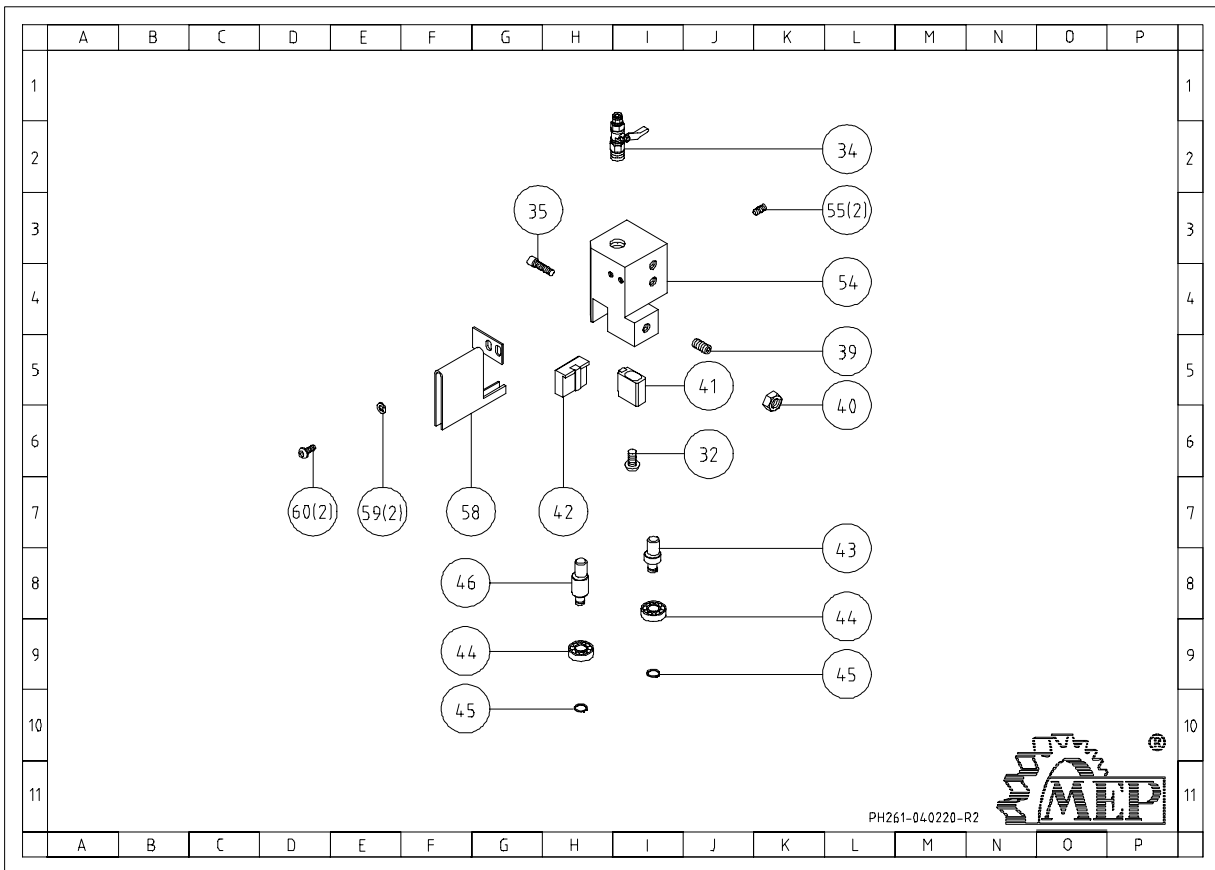

### Assemblage instelbare zaagblad (voorkant)

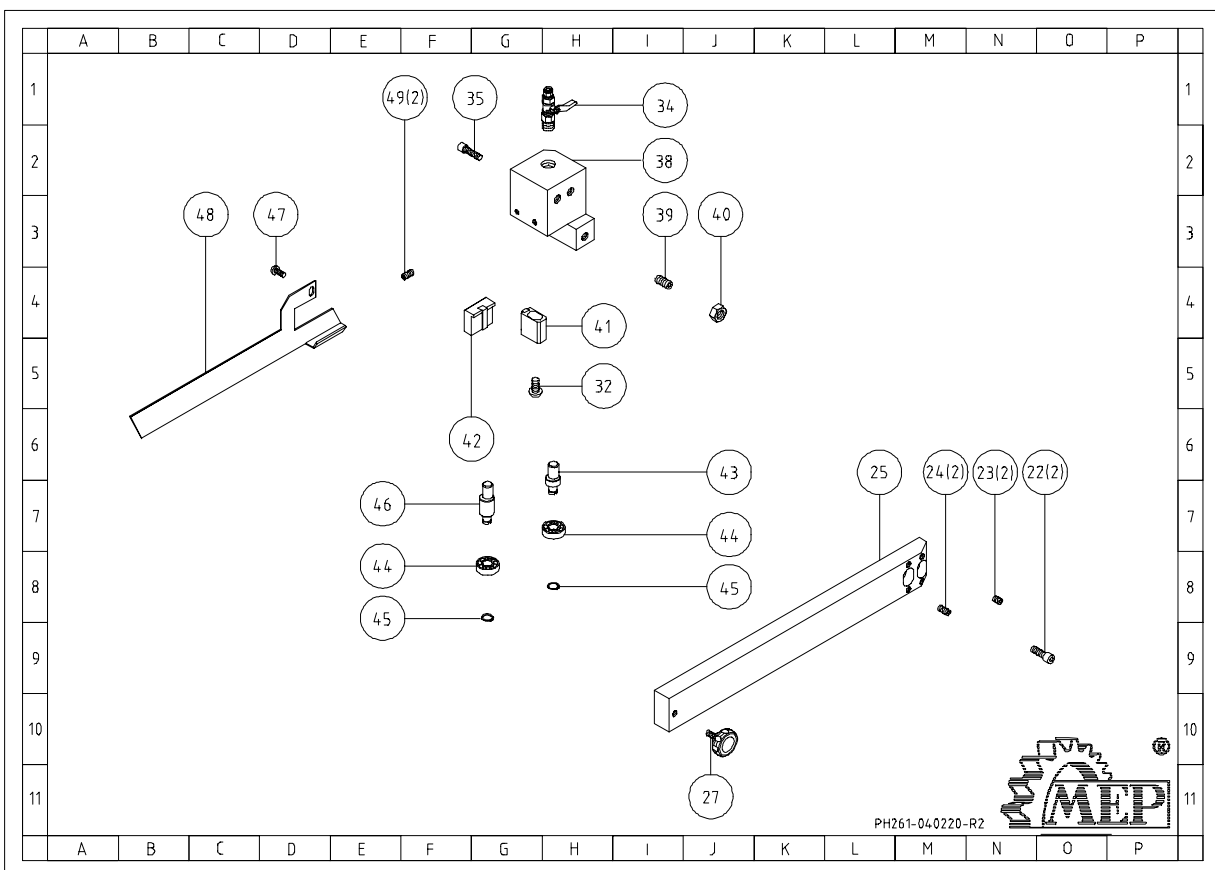

| NR. | Art. NR. | Benaming                          | Hoeveelheid |
|-----|----------|-----------------------------------|-------------|
| 32  | 010.1201 | ROUND HEAD SCREW M6X40L           | 1           |
| 34  | 043.0655 | VALVE 1/8"                        | 1           |
| 35  | 010.1201 | HEX. SOCKET HEAD SCREW M6X8L      | 1           |
| 39  | 010.1201 | HEX. SOCKET HEADLESS SCREW M8X20L | 1           |
| 40  | 010.1201 | HEX. NUT M8XP1,25                 | 1           |
| 41  | 010.1761 | GUIDE                             | 1           |
| 42  | 010.1762 | GUIDE                             | 1           |
| 43  | 010.3707 | ECCENTRIC GUIDE                   | 1           |
| 44  | 025.0901 | BEARING 608-2RS                   | 2           |
| 45  | 010.1201 | C-RETAINER RING Ø 8               | 2           |
| 46  | 010.3708 | ECCENTRIC GUIDE198019             | 1           |
| 54  | 010.2395 | BLADE ADJUSTABLE (REAR)           | 1           |
| 55  | 010.1201 | HEX. SOCKET HEADLESS SCREW M6X6L  | 2           |
| 58  | 016.1174 | BLADE COVER 198032AT              | 1           |
| 59  | 010.1201 | WASHER M5                         | 2           |
| 60  | 010.1201 | ROUND HEAD SCREW M5X10L           | 2           |

| NR. | Art. NR. | Benaming                          | Hoeveelheid |
|-----|----------|-----------------------------------|-------------|
| 22  | 010.1201 | HEX. SOCKET HEAD SCREW M8X20L     | 2           |
| 23  | 010.1201 | HEX. SOCKET HEADLESS SCREW M6X15L | 2           |
| 24  | 010.1201 | HEX. SOCKET HEADLESS SCREW M6X20L | 2           |
| 25  | 010.2354 | BLADE ADJUST STICK                | 1           |
| 27  | 034.1116 | PLUM HANDLE M6X15L                | 1           |
| 32  | 010.1201 | ROUND HEAD SCREW M6X40L           | 1           |
| 34  | 043.0655 | VALVE 1/8"                        | 1           |
| 35  | 010.1201 | HEX. SOCKET HEAD SCREW M6X8L      | 1           |
| 38  | 010.2394 | BLADE ADJUST (FRONT)              | 1           |
| 39  | 010.1201 | HEX. SOCKET HEADLESS SCREW M8X20L | 1           |
| 40  | 010.1201 | HEX. NUT M8XP1,25                 | 1           |
| 41  | 010.1761 | GUIDE                             | 1           |
| 42  | 010.1762 | GUIDE                             | 1           |
| 43  | 010.3707 | ECCENTRIC GUIDE                   | 1           |
| 44  | 025.0901 | BEARING 608-2RS                   | 2           |
| 45  | 010.1201 | C-RETAINER RING Ø 8               | 2           |
| 46  | 010.3708 | ECCENTRIC GUIDE                   | 1           |
| 47  | 010.1201 | ROUND HEAD SCREW M6X15L           | 1           |
| 48  | 016.1173 | BLADE COVER (FRONT)               | 1           |
| 49  | 010.1201 | HEX. SOCKET HEADLESS SCREW M6X6L  | 2           |

### Assemblage gedreven wiel en drijwiel

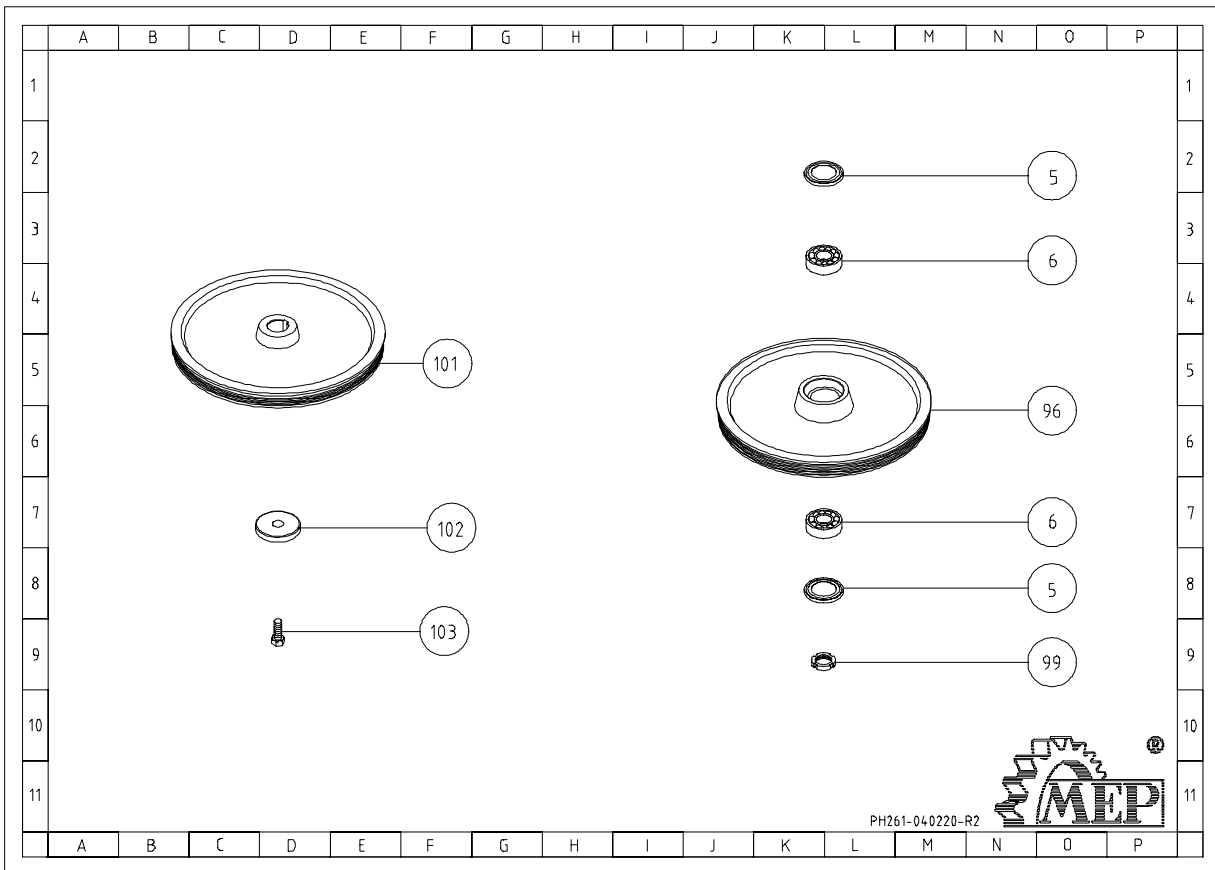

### Assemblage achterste bescherming zaagblad

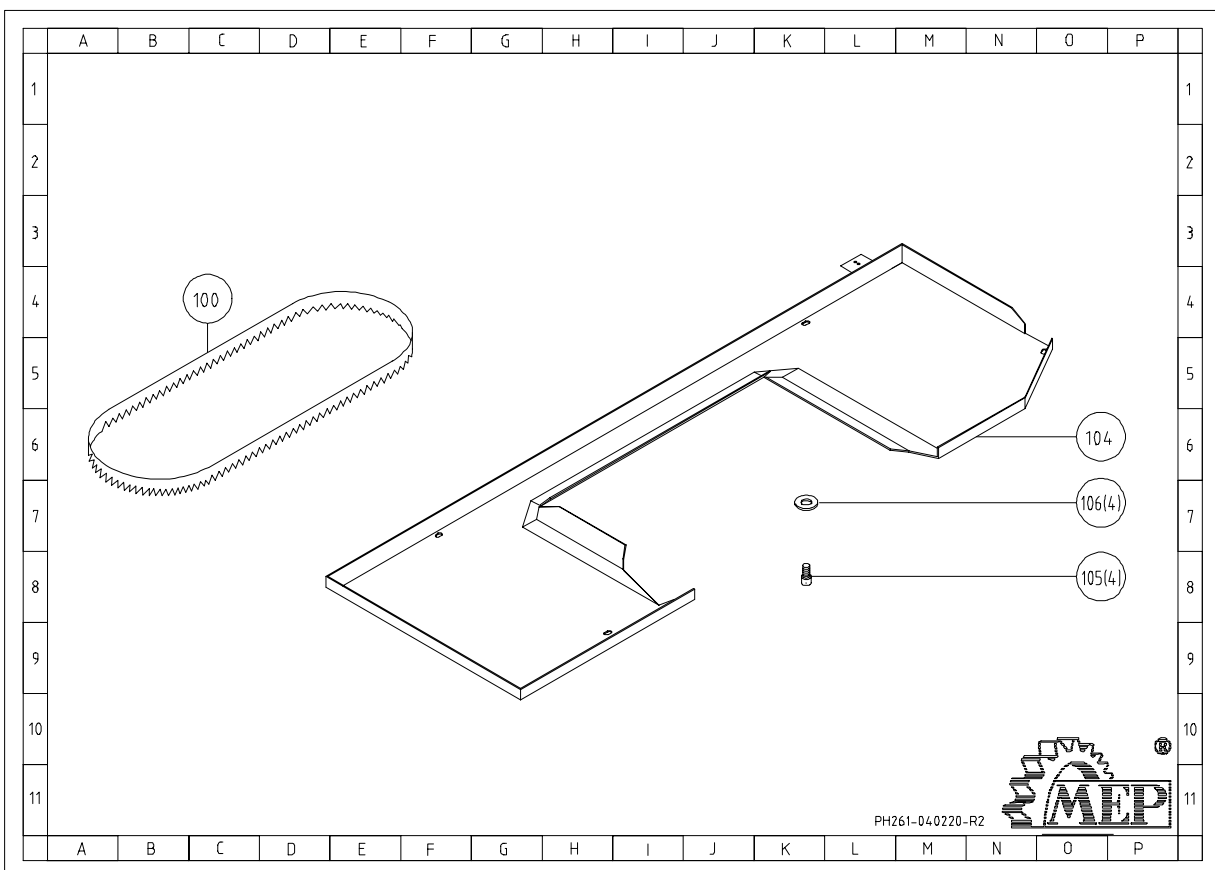

| <b>NR.</b> | <b>Art. NR.</b> | <b>Benaming</b>         | <b>Hoeveelheid</b> |
|------------|-----------------|-------------------------|--------------------|
| 5          | 025.0277        | ANTI-CHIP COVER         | 2                  |
| 6          | 025.0964        | TAPERED BEARING 32006A  | 2                  |
| 96         | 001.6005        | IDLER WHEEL             | 1                  |
| 99         | 010.0359        | NUT AN06                | 1                  |
| 101        | 001.6006        | DRIVE WHEEL             | 1                  |
| 102        | 010.1201        | DRIVE SHAFT WASHER      | 1                  |
| 103        | 010.1201        | HEX. HEAD SCREW M12X30L | 1                  |

| <b>NR.</b> | <b>Art. NR.</b> | <b>Benaming</b>               | <b>Hoeveelheid</b> |
|------------|-----------------|-------------------------------|--------------------|
| 100        | 031.0727        | BLADE 0.9X27X2450X5/8T        | 1                  |
| 104        | 016.0950        | BLADE BACK COVER              | 1                  |
| 105        | 034.1110        | HEX. SOCKET HEAD SCREW M6X13L | 4                  |
| 106        | 010.1201        | WASHER M6                     | 4                  |



### Assemblage bedieningspaneel

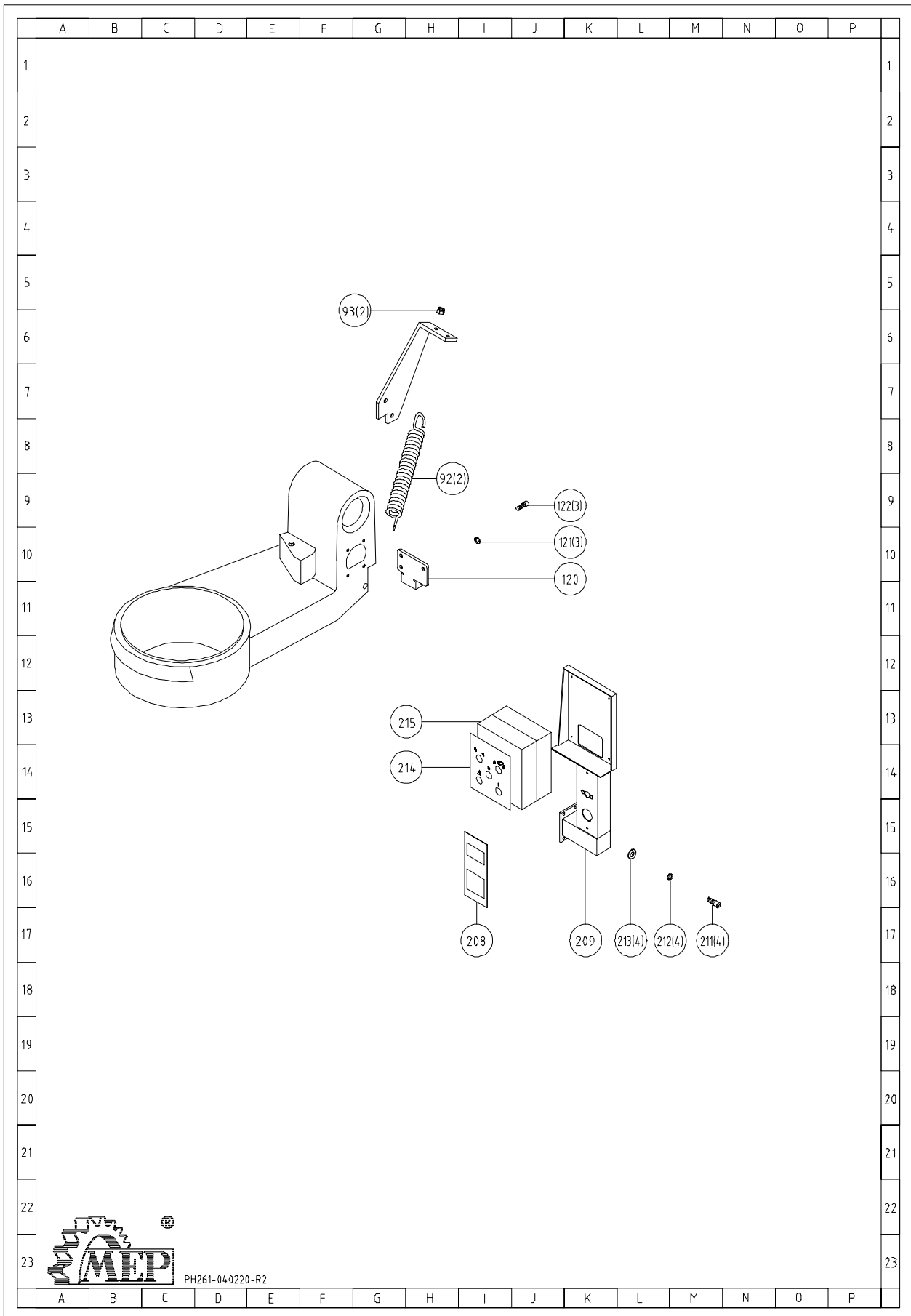

| <b>NR.</b> | <b>Art. NR.</b> | <b>Benaming</b>                | <b>Hoeveelheid</b> |
|------------|-----------------|--------------------------------|--------------------|
| 92         | 010.4061        | SPRING                         | 2                  |
| 93         | 010.1201        | NUT M10                        | 2                  |
| 120        | 010.1591        | SPRING BRACKET                 | 1                  |
| 121        | 010.1201        | SPRING WASHER M10              | 3                  |
| 122        | 010.1201        | HEX. SOCKET HEAD SCREW M10X25L | 3                  |
| 208        | 031.5002        | WARNING PASTER                 | 1                  |
| 209        | 016.0232        | CONTROL BOX BASE               | 1                  |
| 211        | 010.1201        | HEX. SOCKET HEAD SCREW M8X35L  | 4                  |
| 212        | 010.1201        | SPRING WASHER M8               | 4                  |
| 213        | 010.1201        | WASHER M8                      | 4                  |
| 214        | 368.9133        | LABLE FOR NAME PLATE           | 1                  |
| 215        | 368.9133        | CONTROL SWITCH ASSEMBLY        | 1                  |
| 282        | 034.1251        | KNOB                           | 1                  |
| 283        | 010.1201        | HEX.SOCKET HEAD SCREW M8X15L   | 1                  |
| 284        | 010.1201        | HEX.NUT M8                     | 1                  |
| 285        | 010.1201        | SPRING WASHER                  | 1                  |

### Assemblage basis

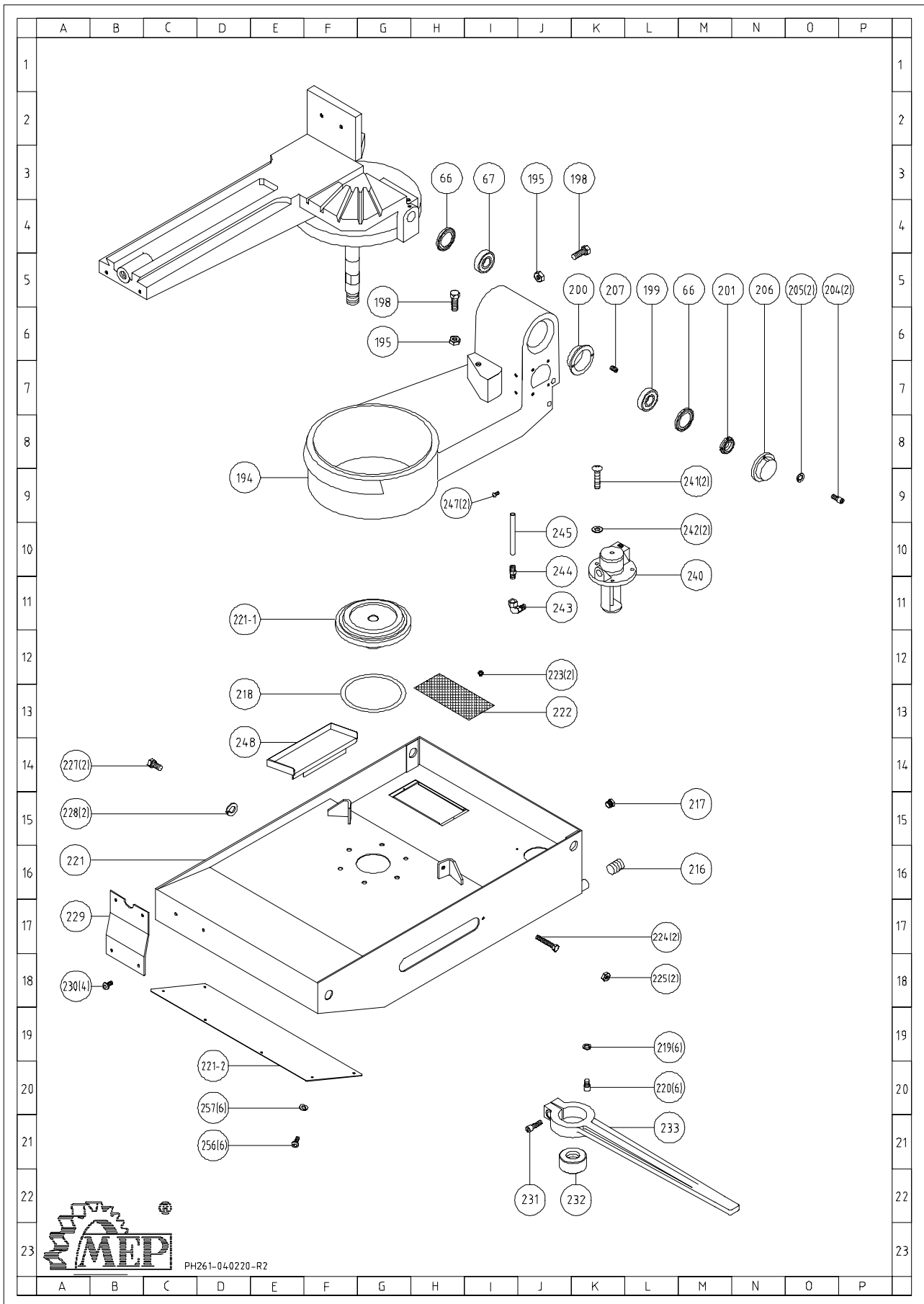

| <b>NR.</b> | <b>Art. NR.</b> | <b>Benaming</b>                   | <b>Hoeveelheid</b> |
|------------|-----------------|-----------------------------------|--------------------|
| 66         | 025.0272        | ANTI-CHIP COVER                   | 2                  |
| 67         | 025.0069        | TAPERED BEARING 32007A            | 1                  |
| 194        | 001.6007        | SWIVEL ARM                        | 1                  |
| 195        | 010.1201        | HEX. NUT M10                      | 2                  |
| 198        | 010.1201        | HEX. HEAD SCREW M10X45L           | 2                  |
| 199        | 025.0069        | BEARING                           | 1                  |
| 200        | 010.2060        | BUSHING                           | 1                  |
| 201        | 010.0354        | NUT AN07                          | 1                  |
| 204        | 010.1201        | HEX. SOCKET HEAD SCREW M6X15L     | 2                  |
| 205        | 010.1201        | SPRING WASHER M6                  | 2                  |
| 206        | 010.2084        | COVER                             | 1                  |
| 207        | 010.1201        | HEX. SOCKET HEADLESS SCREW M6X15L | 1                  |
| 216        | 034.0903        | HEX SOCKET PLUG 3/8"PT            | 1                  |
| 217        | 034.0900        | OIL LEVEL GAGE                    | 1                  |
| 218        | 025.0256        | O-RETAINER RING ID195X5.7W        | 1                  |
| 219        | 010.1201        | SPRING WASHER M10                 | 6                  |
| 220        | 010.1201        | HEX. SOCKET HEAD SCREW M10X20L    | 6                  |
| 221        | 013.0201        | STAND                             | 1                  |
| 221 - 1    | 001.6011        | SWIVEL ARM BASE                   | 1                  |
| 222        | 016.0193        | FILTER                            | 1                  |
| 223        | 010.1201        | CROSS ROUND HEAD SCREW M4X8L      | 2                  |
| 224        | 010.1201        | HEX. HEAD SCREW M10X50L           | 2                  |
| 225        | 010.1201        | HEX. NUT M12XP1,75                | 2                  |
| 227        | 010.1201        | HEX. HEAD SCREW M10X25L           | 2                  |
| 228        | 010.1201        | SPRING WASHER M10                 | 2                  |
| 229        | 016.1235        | FIXED PLATE                       | 1                  |
| 230        | 010.1201        | ROUND HEAD SCREW M6X10L           | 4                  |
| 231        | 010.1201        | HEX. SOCKET HEAD SCREW M10X35L    | 1                  |
| 232        | 010.3463        | NUT                               | 1                  |
| 233        | 001.6001        | ADJUSTABLE HANDLE                 | 1                  |
| 240        | 028.0271        | COOLING PUMP 1/8HP                | 1                  |
| 241        | 010.1201        | CROSS ROUND HEAD SCREW M6X15L     | 2                  |
| 242        | 010.1201        | SPRING WASHER M6                  | 2                  |
| 243        | 043.0227        | MICRO CONTROL BLOCK 3/8"X3/8"     | 1                  |
| 244        | 043.0204        | STRAIGHT CONNECTOR 3/8"X1/4"      | 1                  |
| 245        | 028.0193        | PU TUBE Ø 8X1300L                 | 1                  |
| 247        | 010.1201        | CROSS ROUND HEAD SCREW M5X10L     | 2                  |
| 248        | 016.0192        | FLUID COLLECTED PLATE             | 1                  |
| 249        | 016.1040        | FEED SUPPORT                      | 1                  |

### Assemblage spanklem (A)

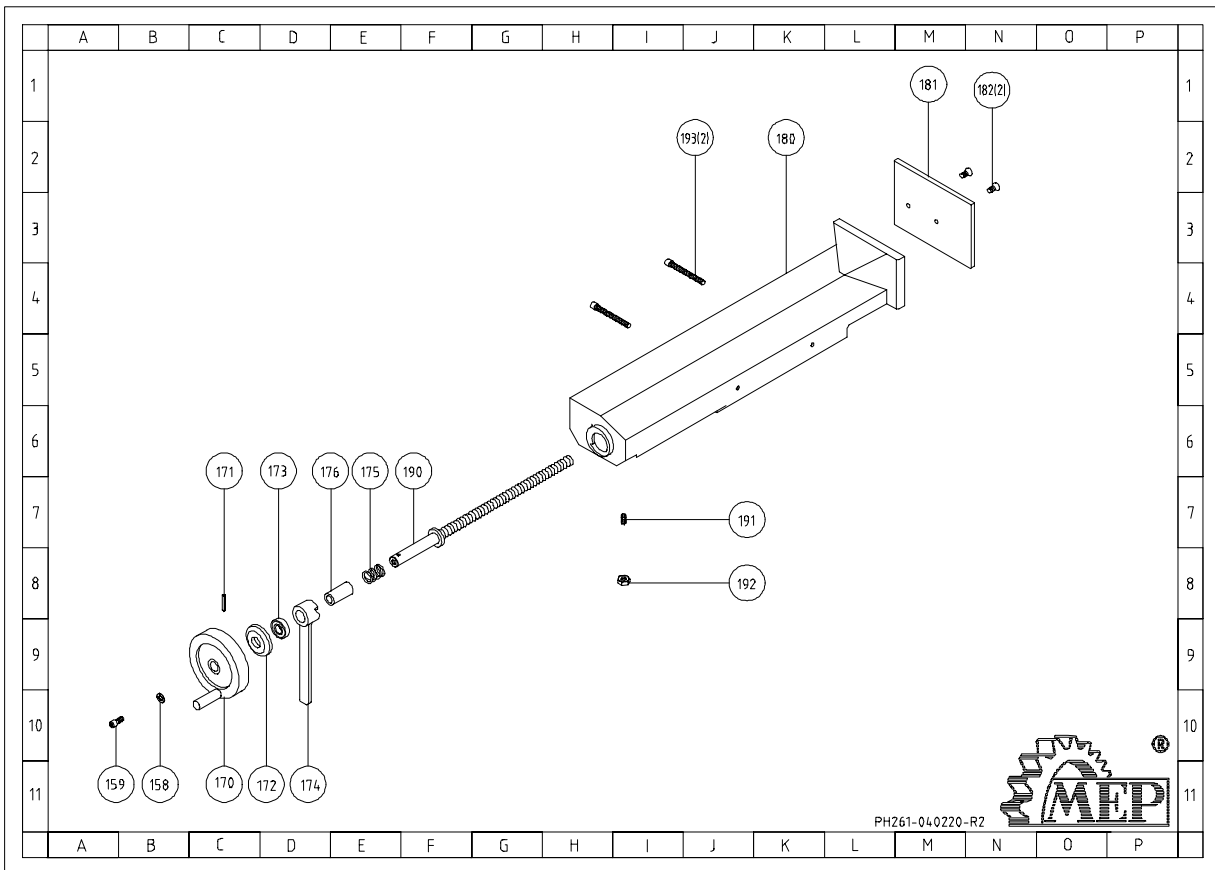

### Assemblage spanklem (B)

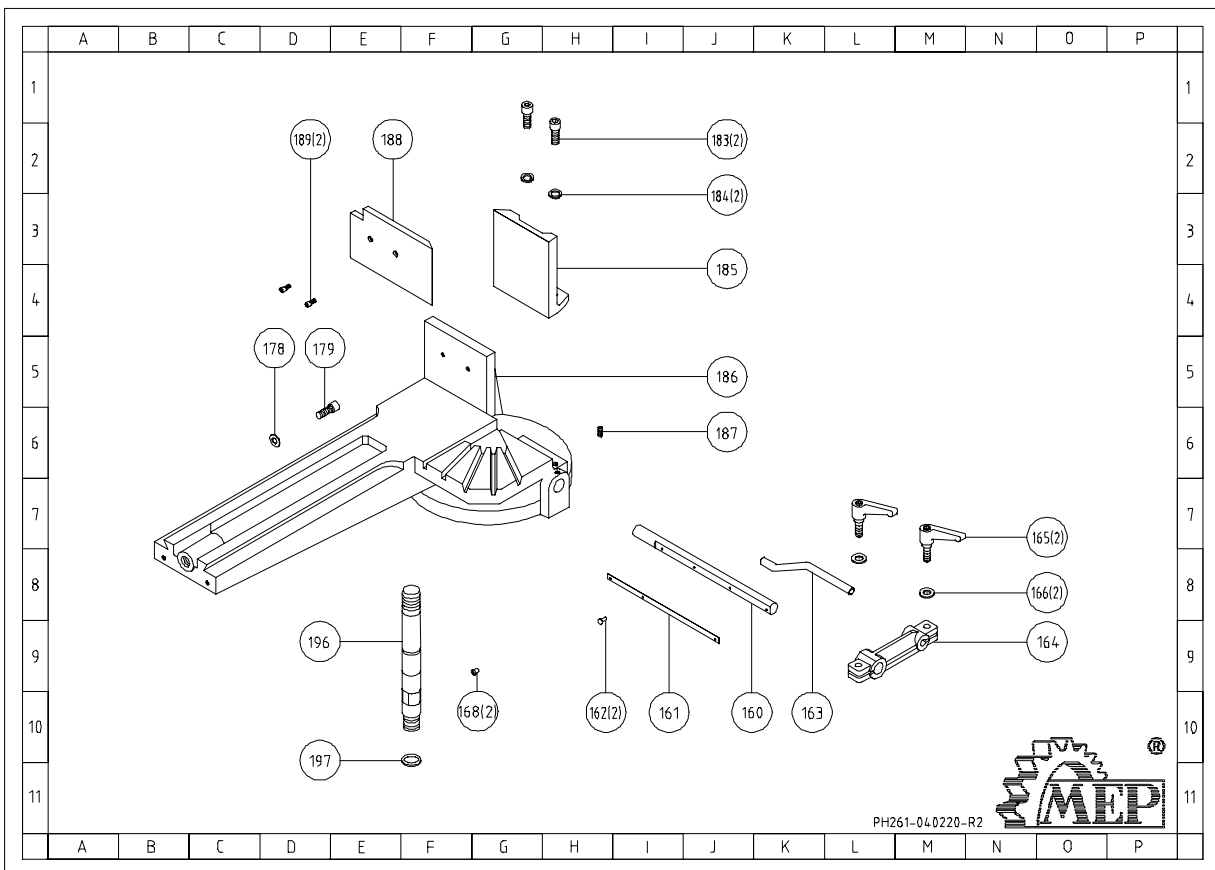

| NR. | Art. NR. | Benaming                           | Hoeveelheid |
|-----|----------|------------------------------------|-------------|
| 158 | 010.1201 | WASHER M6                          | 1           |
| 159 | 010.1201 | HEX. SOCKET HEAD SCREW M6X20L      | 1           |
| 170 | 034.0293 | WHEEL                              | 1           |
| 171 | 010.1201 | PIN Ø 5X35                         | 1           |
| 172 | 010.2085 | BEARING COVER                      | 1           |
| 173 | 025.0965 | BEARING Ø 30X Ø 47X3,5             | 1           |
| 174 | 001.6002 | WISE HANDLE                        | 1           |
| 175 | 010.0892 | SPRING                             | 1           |
| 176 | 010.1699 | BUSHING                            | 1           |
| 180 | 001.6009 | WISE JAW BRACKET (FRONT)           | 1           |
| 181 | 010.0530 | WISE                               | 1           |
| 182 | 010.1201 | HEX. SOCKET FLAT HEAD SCREW M6X12L | 2           |
| 190 | 010.0238 | LEADSCREW A                        | 1           |
| 191 | 010.1201 | HEX. SOCKET HEADLESS SCREW M8X20L  | 1           |
| 192 | 010.1201 | HEX. NUT M8                        | 1           |
| 193 | 010.1201 | HEX. SOCKET HEAD SCREW M6X120L     | 2           |

| NR. | Art. NR. | Benaming                          | Hoeveelheid |
|-----|----------|-----------------------------------|-------------|
| 160 | 010.2356 | DISTANCE SET ROD                  | 1           |
| 161 | 031.3607 | SCALE                             | 1           |
| 162 | 010.1201 | RIVET Ø 2                         | 2           |
| 163 | 010.3166 | STOCK STOP ROD                    | 1           |
| 164 | 001.6003 | DISTANCE SET BRACKET              | 1           |
| 165 | 034.1001 | KNOB                              | 2           |
| 166 | 010.1201 | WASHER M8                         | 2           |
| 168 | 010.1201 | RIVET Ø 2X6                       | 2           |
| 178 | 010.1201 | WASHER ID Ø 6,5 OD Ø 18           | 1           |
| 179 | 010.1201 | HEX. SOCKET HEAD SCREW M6X15L     | 1           |
| 183 | 010.1201 | HEX. SOCKET HEAD SCREW M10X30L    | 2           |
| 184 | 010.1201 | SPRING WASHER M10                 | 2           |
| 185 | 001.6008 | WISE                              | 1           |
| 186 | 001.6012 | WISE JAW BRACKET (REAR)           | 1           |
| 187 | 010.1201 | HEX. SOCKET HEADLESS SCREW M8X10L | 1           |
| 188 | 010.0529 | WISE                              | 1           |
| 189 | 010.1201 | HEX. SOCKET HEAD SCREW M6X15L     | 2           |
| 196 | 010.3710 | WISE JAW ADJUSTABLE ROD           | 1           |
| 197 | 025.0257 | O-RETAINER RING Ø 19.8X Ø 2.4     | 1           |

### Assemblage steunpoot

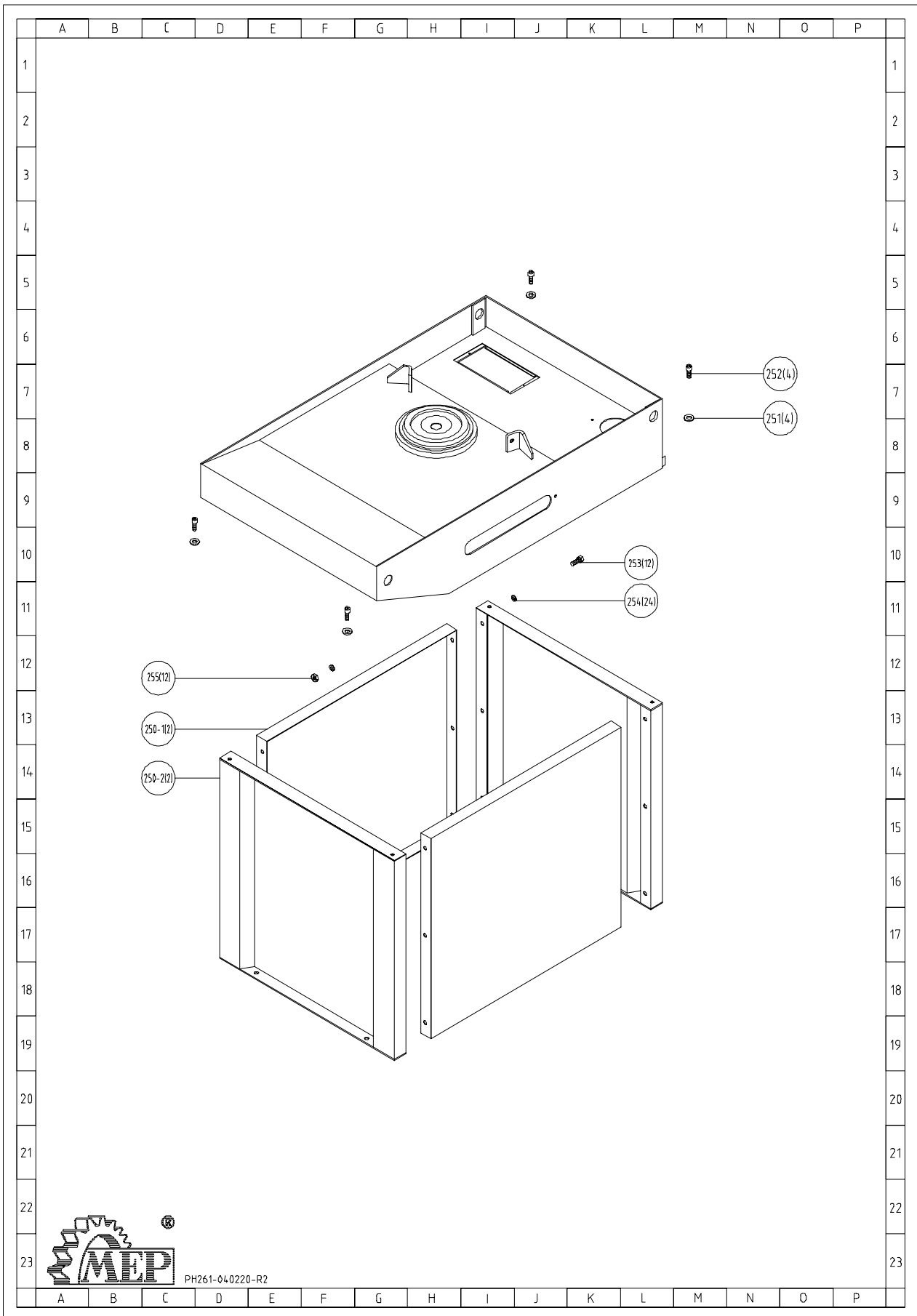

| <b>NR.</b> | <b>Art. NR.</b> | <b>Benaming</b>                | <b>Hoeveelheid</b> |
|------------|-----------------|--------------------------------|--------------------|
| 250-1      | 013.0204        | STAND LEG (FRONT)              | 2                  |
| 250-2      | 013.0204        | STAND LEG (RIGHT)(LEFT)        | 2                  |
| 251        | 010.1201        | WASHER M10                     | 4                  |
| 252        | 010.1201        | HEX. SOCKET HEAD SCREW M10X20L | 4                  |
| 253        | 010.1201        | HEX. HEAD SCREW M8X20L         | 12                 |
| 254        | 010.1201        | WASHER M8                      | 24                 |
| 255        | 010.1201        | HEX. NUT M8                    | 12                 |